

AAIDD FINAL PROGRAM

Supports for Quality Living

May 21–24, 2007
Sheraton Atlanta Hotel
Atlanta, Georgia

First Meeting of the AAIDD
and the 131st Annual Meeting
& Exhibit Show of the Association



American Association
on Intellectual and
Developmental Disabilities





Knowledge | Support | Empowerment



On behalf of our local arrangements committee, the National office staff, and our board of directors, it is my honor to welcome you to Atlanta for a landmark annual meeting. This is our 131st annual meeting as an association, but this is our first meeting under our new name. Let me be the first to welcome you to our first annual meeting as the American Association on Intellectual and Developmental Disabilities (AAIDD).

We have a new look: a new name, a new logo, a new governance structure, and a new style to the annual meeting. We hope you will find these changes exciting and affirming of our joint vision for this fine association. From our new by laws and constitution, to our new name, logo and tag line, these changes signal a dynamic rebirth for our association.

Our mission remains unchanged: to promote progressive policies, sound research, effective practices, and universal human rights for people with intellectual and developmental disabilities. Our new tag line— *Knowledge | Support | Empowerment*—reflects the new way of thinking about what we do and how we do it.

This week, members from across the US, and from across the globe are gathered together around the conference theme of “Supports for Community Living.” This is a fitting theme as we strive to implement our mission, and to provide knowledge, support and empowerment.

For my presidential address, I have chosen the title: “The Past is Prologue.” We have spent the last 131 years as an association becoming who we are today. While we carry forward our successes and our shortcomings of the past, and we are also filled with a vision of the future. This annual meeting is an opportunity to capture our chart the course to that future together.

This week we will meet, discuss, present and debate. We will share meals, give and receive awards, socialize and conduct business. Our hope is that you will take advantage of the opportunities to make new friends, sustain old relationships, encounter new ideas, and to think about old issues in the field the field in new ways. In particular, I am asking our leadership to extend especially warm welcomes to students, young professionals and those of you attending a meeting for the first time.

Individually we are strong, committed, talented, experienced individuals. Together we are AAIDD, the oldest and largest interdisciplinary organization of professionals (and others) concerned about intellectual and related developmental disabilities.

Welcome to Atlanta.

Hank Bersani Jr.

Hank Bersani Jr., Ph.D.
President



Knowledge | Support | Empowerment



Welcome to Atlanta! While this is our Association's 131st Annual Meeting, it is the first under our new name of the *American Association on Intellectual and Developmental Disabilities*. I hope that your participation in this conference provides you with information and networking that supports your professional growth.

This conference provides the opportunity for us all to gain new insights in Support for Quality Living for people with intellectual and developmental disabilities. Presentations focus on current research in the field, its practical application by support providers, and the benefits for recipients. You will see the multidisciplinary strength of the AAIDD reflected in the depth and variety of the plenaries, theme-based sessions, and workshops.

Each plenary session includes multiple presenters on a single topic, combining perspectives to provide current and stimulating information that we can all use. In the opening plenary session, Val Bradley, immediate past president of AAIDD and CEO of Human Services Research Institute, and Liz Weintraub, service recipient, self-advocate, and quality consultant for the Council on Quality & Leadership, will discuss the topic of quality of services and supports with perspectives from the systems and individual levels. Derrick Dufresne, senior partner of Community Resource Alliance; Bob Laux, president of Wild River Consulting Group; and Mark Straka of Community Access Unlimited will inform us, in the second plenary, on home ownership and control of housing by people with disabilities. Dr. Julie Gerberding, MD, director of the Centers for Disease Control and Prevention, and a CDC colleague will present a plenary on health protections for people with intellectual and developmental disabilities. They will address issues in prevention of diseases, injuries, and disabilities and also discuss emergency preparedness for people with disabilities. Dr. Marc Tassé, Assistant Director of the Florida Center on Inclusive Communities (UCEDD), and Dr. James LeVelle, State Director of Psychological Services for the Louisiana Office for Citizens with Developmental Disabilities, will present a plenary that provides evidence-based and practical information on the respective role and importance of people's adaptive skills and individual support needs.

Concurrent sessions are replete with research, training, health, advocacy, and spirituality focused information to enhance supports for quality living. A sample of topics from concurrent sessions includes clinical, judgment and liability issues related to sexuality; ethics and their application; training for direct support professionals; advocacy; SIS use from a statewide perspective and for resource allocation; supports coordination; evaluation of a state QA/QI system; inclusive education; community inclusion; health care; healthy environments; and preparing and supporting future leaders.

We welcome and value your participation. We look forward to seeing you at the sessions and at social events such as the exhibit hall reception and the awards ceremony and reception. Please let me and the other AAIDD Board members and staff know what you think of the conference and the newly reorganized association and how we can work together to continue our mission.

A handwritten signature in black ink that reads "David Rotholz".

David A. Rotholz, PhD
President-Elect and Program Chair

Supports for Quality Living

Welcome to the 131st Annual Meeting of the American Association on Intellectual and Developmental Disabilities, *Supports for Quality Living*, here in Atlanta! We are delighted that you chose to join your colleagues and friends to enhance your skills and knowledge on quality supports.

We are brought together from all over the country by our common interest and commitment to people with intellectual and developmental disabilities. But since we are in Atlanta, we feel a little Southern orientation will ensure that all y'all enjoy real southern hospitality during your stay.

- First, you folks need to learn to use “y'all” correctly. In the South, when you address one person, you say “you.” To address two or three people, you say “y'all,” a contraction for the words “you” and “all.” For four or more, we say “All y'all.”
- Next, when seeking directions, remember that the famous Peachtree Street is the east/west divider of the city and that there are more than 100 streets with Peachtree in their name. In Marietta, a suburb of Atlanta, the reference point is the Big Chicken.
- You will not need to remember the first names of the people you meet at the Conference, because here in the South, we call everyone Darlin', Sugah, or Honey.
- If you need to say anything negative about someone in the South, it is always followed by “Bless her/his heart.” For example, you might say, “She was wearing a tacky dress. Bless her heart.”
- When you order iced tea in the South, it will be sweet tea, also known as the “Table Wine of the South.” You Yankees will need to ask for unsweetened tea.
- You may hear the reply, “Yes m'am” or “No, sir” when asking a question. This is not sass; it is southern manners at work.

Since each day will be filled with great presentations and enhancing our skills, we have planned to unwind on Tuesday evening, just for fun, southern style. We hope that we can draw upon our collective sense of humor to have fun with our geographic differences, through some Northern and Southern Trivia. Then, all y'all can try your luck at navigating through the Atlanta Airport (the world's busiest), test your speed in a Peanut Shelling Contest, sip a mint julep, and sample some southern food.

Please take a few moments to look through your goodie bags; they have lots of information on places to go and things to do. The Marketplace will have items you will want to buy. If you need help or directions, tag one of our great volunteers. We want to make sure you enjoy your stay.

And, trusting that even all y'all who were born and reared someplace outside the South (Bless your hearts) can be a little southern in your heart while you are here, we warmly welcome you to Atlanta. Come on in. Make yourself at home, Sugah.

The Local Arrangements Committee

Janet Deal, ResCare, *Co-Chair*

Renee Simoneaux, The Frazer Center, *Co-Chair*

Dottie Adams, Governor's Council on Developmental Disabilities

Sheryl Arno, DeKalb Developmental Disabilities Council

Robyn Berger, DeKalb Developmental Disabilities Council

Dave Blanchard, Atlanta Alliance on Developmental Disabilities

Carol Perkins, Georgia Mountains Community Services

Kate Gainer, Governor's Council on Developmental Disabilities

Sue Burgess, Atlanta Regional Commission on Aging

Sara Case, DeKalb Community Service Board

Deborah Conway, Cross Plains Community Partner

Rie Kennedy-Lizotte, Division MHDDAD, Office of Developmental Disabilities

Lisa Morgan, Jewish Family & Career Services

Mickie Muroff, Division MHDDAD, Intake & Evaluation Unit

Barbara Wood, Georgia AAIDD Chapter, AAIDD Fellow

Martha DeHart, Georgia AAIDD Chapter

AAIDD Georgia Chapter

aaidd arrives in atlanta

Welcome Reception

Tuesday Evening
in the Exhibit Hall
5:45 pm–7:30 pm

The AAIDD Leadership and the Local Arrangements Committee welcome you to the 131st Annual Meeting.

Sponsored by AAIDD Southern Region and the Georgia Chapter

AAIDD Open Annual Meeting for Members and Leadership Forum

Monday, May 21
1:15 pm–3:00 pm

Interactive Poster Sessions

Exclusive time with presenters

Tuesday, May 22
4:45 pm–5:45 pm

Examine Key Topics In Depth

Explore the many facets of support for quality living at Thursday's Professional Workshops. Practitioners and experts in the field will present sessions on key topics such as community involvement, self-advocacy, best practices, literacy instruction, evaluation, full inclusion, and socialization/sexuality education. See page ___ for more information.

Monday Night at the Movies

Meet the Stars

Body and Soul: Diana and Kathy

2007 AAIDD Media Award Winner

Monday, May 21, 7:30 pm

- 4 Program-at-a-Glance
- 5 Annual Meeting Sponsors
- 6 Pre-Conference on Aging
- 7 Annual Meeting Program
- 7 Welcome Reception
- 7 Opening Session
- 7 Plenary Session: Quality
- 9 Plenary Session: Housing
- 12 Plenary Session: Health
- 14 Plenary Session: Assessment
- 15 Open Forum
- 16 Presidential Address
- 16 Awards Ceremony
- 18 NADD/AAIDD Symposia
- 19 Religion & Spirituality Program
- 19 Professional Workshops
- 21 The Academy Program
- 22 Poster Sessions
- 25 Business Meetings
- 27 General Information
- 28 Guide to Exhibitors
- 28 Exhibit Hall Schedule
- 29 Exhibit Floor Plan
- 33 Hotel Floor Plan



program-at-glance

	MONDAY, MAY 21	TUESDAY, MAY 22	WEDNESDAY, MAY 23	THURSDAY, MAY 24
morning	<p>Pre-Conference</p> <p>Special Symposium on Aging 9:00 am–5:00 pm</p> <p>Board Meeting 10:00 am–12:00 noon</p>	<p>Business Meetings 7:00 am–8:00 am</p> <p>Exhibit Hall Opening 8:00 am–9:00 am</p> <p>Opening Plenary Session 9:00 am–10:30 am</p> <p>(5) Special Theme Sessions 10:45–12:15 pm</p>	<p>Business Meetings 7:00 am–8:00 am</p> <p>Exhibit Hall Time 8:00 am–9:00 am</p> <p>Plenary Session 9:00 am–10:15 am</p> <p>Exhibit Hall Open 10:00 am–1:30 pm</p> <p>(5) Special Theme Sessions 10:45 am–12:15 pm</p>	<p>Business Meetings 7:00 am–8:00 am</p> <p>(5) Half-Day Morning Workshops 9:00 am–12:00 noon</p> <p>NADD Symposium I 9:00 am–12:00 noon</p> <p>Two-Day Workshop 9:30 am–5:00 pm</p>
afternoon	<p>Open Annual Meeting for Members and Leadership Forum 1:15 pm–3:00 pm</p> <p>Breakout Leadership Meetings 3:15 pm–5:00 pm</p>	<p>Exhibit Hall Open 12:15–1:45 pm</p> <p>Plenary Session 1:45 pm–3:00 pm</p> <p>(5) Special Theme Sessions 3:15 pm–4:45 pm</p> <p>Exclusive Interactive Poster Sessions with Presenters 4:45 pm–5:45 pm</p>	<p>Plenary Session 1:30 pm–2:45 pm</p> <p>(5) Special Theme Sessions 3:00 pm–4:15 pm</p> <p>Presidential Address 4:30 pm–5:30 pm</p> <p>Awards Ceremony 5:30 pm–6:30 pm</p>	<p>(5) Half-Day Afternoon Workshops 1:00 pm–4:00 pm</p> <p>NADD Symposium II 1:00 pm–4:00 pm</p>
evening	<p>Movie Night 7:30 pm</p>	<p>Exhibit Hall Reception 5:45 pm–7:30 pm</p>	<p>Awards Cocktail Reception 6:30 pm</p>	<p>FRIDAY, MAY 25</p> <p>Two-Day Workshop 8:30 am–3:30 pm</p>

131st AAIDD Annual Meeting

Sheraton Atlanta Hotel

165 Courtland Street NE • Atlanta, GA 30303

Phone 404.659.6500

aaidd says thank you...

to Our Generous Sponsors for Contributing to
the Success of Our 131st Annual Meeting

Silver Sponsors

AAIDD Georgia State Chapter
www.gaaamr.org

AAIDD Southern Region
www.seaamr.org

Community Access Unlimited
www.caunj.org

Marcus Institute
www.marcus.org

Bronze Sponsors

**Coleman Institute for
Cognitive Disabilities**
www.cu.edu/ColemanInstitute

**Center for Disability Resources
(a UCEDD)**

University of South Carolina
www.uscm.med.sc.edu/cdrhome/

College of Direct Support
www.collegeofdirectsupport.com

The MENTOR Network
www.thementornetwork.com

**AAIDD New Jersey
State Chapter**

In honor of Bob Laux
www.aaidd.org/groups

AAIDD Region IX
www.aaidd.org/groups

**AAIDD Religion and
Spirituality Division**
www.aaiddreligion.org

In Kind Sponsors

Governor's Council on
Developmental Disabilities

Department of Human Resources/
Division MDDAD/
Office of Developmental Disabilities

ResCare	Kate Gainer
Martha DeHart	Carol Perkins
Barbara Wood	Dave Blanchard
Mickie Muroff	Robyn Berger
Lisa Morgan	Sheryl Arno
Rie Kennedy-Lizotte	Dottie Adams
Debbie Conway	Renee Simoneaux
Sara Case	Janet Deal
Sue Burgess	

Annual Meeting Bags

Provided by



DDMS

AAIDD Georgia Chapter

MONDAY, MAY 21

Registration

7:00 am–12:00 noon

10:00 am–12:00 noon

AAIDD Board of Directors Meeting

Presiding: Hank Bersani, Jr., PhD

Room: Atlanta 5–Level One

1:15 pm–3:00 pm

Open Annual Meeting for Members and Leadership Forum

Presiding: Hank Bersani, Jr., PhD

Room: Capitol South–Level One

3:15 pm–5:00 pm

The Assembly of Geographic Interests

Presiding: David Rotholz, PhD

Room: Atlanta 4–Level One

3:15 pm–5:00 pm

The Conference of Professional Interests

Presiding: Steve Eidelman

Room: Atlanta 5–Level One

6:00 pm–7:30 pm

T & C Committee Meeting

Presiding: Robert Schalock, PhD

Room: Atlanta 5–Level One

MONDAY, MAY 21

9:00 am–5:00 pm

Pre-Conference Symposium on Aging State of the Science in Aging with Developmental Disabilities: Charting Lifespan Trajectories and Supportive Environments for Healthy Community Living

This pre-conference, organized by the Rehabilitation Research and Training Center on Aging with Developmental Disabilities at the University of Illinois at Chicago, presents the current knowledge on the social, environmental, and technological supports needed to promote the health and community participation of adults with intellectual and developmental disabilities across their life course. Key international researchers will present the latest research findings and their practice applications and set the agenda for future research in four thematic areas:

- Neuro-developmental conditions
- Health promotion, health literacy, and health services
- Family support and intergenerational caregiving
- Environmental barriers and supports to community living

Keynote Speakers

Ted Brown
David Braddock

Margaret Campbell
Tamar Heller

James Rimmer
Marsha Seltzer

Key Sponsors

National Institute on Disability and Rehabilitation Research
Coleman Institute for Cognitive Disabilities, University of Colorado
College of Applied Health Sciences, University of Illinois at Chicago
American Association on Intellectual and Developmental Disabilities
Centers for Disease Control and Prevention

Co-Sponsors

Association of University Centers on Disabilities
International Association for the Scientific Study of Intellectual Disabilities
Institute on Human Development and Disability, University of Georgia
Easter Seals

Room: Capitol North–Level One

MONDAY, MAY 21

7:30 pm

Monday Night at the Movies

BODY AND SOUL: Diana and Kathy

An intimate portrait of two women with disabilities who are determined to live independent, non-institutionalized lives.

Come and meet special guests Alice Elliott, Director, and the stars, Diana and Kathy.

Room: Capitol South–Level One

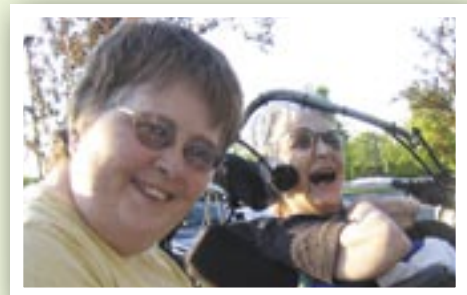

TUESDAY, MAY 22

Registration

7:00 am–5:00 pm

**Exhibit Hall and
Poster Presentations**

8:00 am–9:00 am

Continental Breakfast

12:15 pm–1:45 pm

Exhibit Hall Open

4:45 pm–5:45 pm

**Exclusive Time for Poster
Presentations with Presenters**

5:45 pm–7:30 pm

**Welcome Reception
in the Exhibit Hall**

Room: Georgia Hall–Level One

Business Meetings

7:00 am–8:00 am

Journal Editors Meeting

Presiding: Bruce Appelgren

Room: Conference Room 125

7:00 am–8:00 am

**Religion and Spirituality Division
Meeting**

Presiding: Rev Jeanne Lloyd

Room: Atlanta 5–Level One

7:00 am–8:00 am

T & C Committee Meeting

Presiding: Robert Schalock, PhD

Room: Conference Room 127

7:00 am–8:00 am

Multicultural Special Interest Group

Presiding: Geronimo Robinson

Room: Conference Room 129

7:30 am–8:00 am

**Orientation for First Time Annual
Meeting Attendees**

If this is your first AAIDD Annual Meeting, please join AAIDD Mentors for an orientation.

Presiding: Hank Bersani, Jr, PhD

Room: Capitol South–Level One

8:00 am–8:30 am

**Reflection Times: "Integrating Faith
and Professional Practice: A Time
for Reflection and Meditation"**

Room: Atlanta 5–Level One

TUESDAY, MAY 22

9:00 am–10:30 am

Opening Session

Presiding: Hank Bersani Jr, PhD, AAIDD President

Introductions: David Rotholz, PhD, AAIDD President Elect and Program Chair

Plenary Session on Quality

**Quality of Services and Supports—
Perspectives from the Individual and Systems Level**

Moderator: Robert Schalock, PhD

*Val Bradley, President, Human Services Research Institute and
Liz Weintraub, The Council on Quality and Leadership*

This session will emphasize the importance of designing quality improvement systems that are based on the aspirations and needs of people with intellectual and other developmental disabilities. Liz Weintraub will discuss her own experiences as a recipient of services, and will describe what quality means in her own life and the lives of other self-advocates. She also will reflect on her experiences as a quality consultant working for the Council on Quality and Leadership. Val Bradley will discuss recent trends in quality improvement at the systems level, including recent changes in quality expectations at the Centers for Medicare and Medicaid Services. She also will focus on the use of consumer feedback and individual outcomes as integral parts of quality management strategies. Finally, she will describe how some states are increasing the transparency of their developmental disabilities systems by creating stakeholder quality councils, posting service evaluations on the web, and circulating information on quality directly to interested families and people with disabilities.

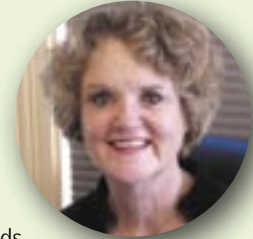

Room: Capitol North/Center–Level One

8:00 am–9:00 am

Exhibit Hall Opening

Complimentary Continental Breakfast

Room: Georgia Hall–Level One

8:00 am–5:00 pm

Speaker Ready Room

Room: Georgia 14–Level One

5:00 pm–6:00 pm

Awards and Fellowship Committee

Presiding: Carolyn Graff, PhD

Room: Atlanta 1–Level One

5:00 pm–6:00 pm

AAIDD Southern Region

Presiding: Anita Bowles

Room: Atlanta 2–Level One

5:00 pm–6:00 pm

SIS Implementation Committee

Presiding: Val Bradley

Room: Atlanta 5–Level One

5:30 pm–6:30 pm

Nursing Action Group Meeting

Presiding: Lee Barks, PhD

Room: Atlanta 3–Level One

SPECIAL THEME SESSION

10:45 am–12:15 pm

**Sexuality: Clinical Judgment,
Consent, and Liability**

Moderator: Sharon Gomez

Ruth Luckasson, JD, UNM-SPCD Program; Leslie Walker-Hirsch, MEd, Moonstone; John Rose, Irwin Siegel Agency, Inc

The role of clinicians, agencies, and the law to support rather than promote or unnecessarily restrict responsible expressions of sexuality is still unclear. This panel will address procedures for establishing a rationale for providing reasonable support within the law and reducing agency liability.

Room: Valdosta–Level Two

SPECIAL THEME SESSION

10:45 am–12:15 pm

Medical Treatments and Protocols: Déjà vu 1890?

Moderator: Bill Gaventa, MDiv

Death by Committee: An Examination of the Groningen Protocol

Rick Rader, MD, Orange Grove Center

The Department of Pediatrics at the University Medical Center in Groningen, Netherlands, has implemented a protocol that unilaterally terminates the life of “extraordinarily ill newborns.” This session presents the criteria used, the rationale, and the reaction by the disability community.

Hormonal Treatment and Hysterectomy to Limit Somatic Growth: Ethical Review of the Gunther and Diekema Protocol

David Coulter, MD, Harvard Medical School

Can we provide sufficient supports for individuals and families as the individuals’ care needs become more challenging? The discussion will include concerns that parents and other caregivers have as their children grow physically; ethical aspects of growth attenuation; risks and benefits of treatment options; and social policy implications of organizing adequate supports.

Room: Macon–Level Two

SPECIAL THEME SESSION

10:45 am–12:15 pm

Workers on the Front Line

Moderator: Susan Havercamp, PhD

Critical Competencies and Priority Training Needs for Frontline Supervisors

Robert Doljanac, PhD, Sheryl Larson, PhD, Amy Hewitt, PhD, and Patricia Salmi, PhD, Institute on Community Integration–University of Minnesota

This session presents a national validation of the Minnesota Frontline Supervisor Competencies and Performance Indicators, including rankings of the most important competencies, the greatest training needs, and an identification of which competencies are needed at hire and within 90 days of hire. Implications for selection, orientation, and training programs will be explored.

Direct Support Professional Initiative

Katie Keiling and Tia Nellis, Institute on Disability and Human Development

at the University of Illinois at Chicago; Amy Hewitt, PhD, Institute on Community Integration–University of Minnesota

The presenters will highlight effective strategies used in Illinois to create statewide systems change around direct support workforce issues through a partnership between the Illinois and Minnesota UCEDDs as well as HSRI. They also will share a variety of tools to improve the recruitment and retention of direct support professionals.

Career Development for Direct Support Professionals in New Jersey

Colleen McLaughlin, MEd, The Elizabeth M. Boggs Center on Developmental Disabilities

The New Jersey Direct Support Professional Workforce Development Coalition developed a process to improve the retention and skills of direct support professionals (DSPs) in the state. This presentation will provide information about the process the coalition completed to determine the most effective certification process for the state.

Implementing Statewide Change through a System of Professional Development

Frank Shweigert, OMR Consulting System

The Pennsylvania Department of Public Welfare Office of Mental Retardation implemented a statewide training system based on the principles of Everyday Lives. This training system focuses on linking federal requirements, state policy, and best practices through a consistent system of professional development.

Room: Athens–Level Two

SPECIAL THEME SESSION

10:45 am–12:15 pm

Self Advocates Take Action

Moderator: Diane Morin, PhD

Shifting Paradigms: Moving from Work to a Career

Nathan Perry, Institute on Community Integration–University of Minnesota; Derek Nord, MSW, University of Minnesota; John Sauer, MSW, Beach Center on Disability, University of Kansas

Perry, a self-advocate, and two members of his support team will share their experiences with consumer-directed community supports in identifying, finding, and maintaining a career. They will discuss the challenges and successes they faced and the approaches, processes, and resources they used to develop a focused career plan to help

Perry find a profession in the disability and advocacy fields.

Self-Advocates Defining and Directing Our Own Support Assessments

Gail Bottoms, Toney Duvall, Marian Jackson, and Vici Lu Decker from the IHDD Experts on Disability Speakers Bureau

Speakers from the Experts on Disability Speakers Bureau at the University of Georgia will relate their experiences as self-advocates supported to have control over their own lives. Decker, their program coordinator, will share her efforts to support them.

My Health, My Choice, My Responsibility

Marilyn Vitale, Steve Holmes, James Huben, Daniel Crimmins, PhD, and Mitchell Levitz, Westchester Institute for Human Development

My Health, My Choice, My Responsibility is a curriculum for adults with intellectual disabilities that promotes making healthy choices and speaking up for good health in daily life. The speakers will describe the development, field testing, and initial results of the program, which pairs a trainer and a self-advocate as group leaders.

Room: Capitol South–Level One

SPECIAL THEME SESSION

10:45 am–12:15 pm

Statewide Quality Assurance System

Moderator: Val Bradley

Evaluating the Validity of a Statewide QA System Using the CMS Quality Framework

David Rotholz, PhD, University of South Carolina School of Medicine; Charlie Lakin, PhD, ICI–University of Minnesota; Kathi Lacy, PhD, South Carolina Dept. of DSN; Chas Moseley, EdD, National Association of State Directors of Developmental Disabilities Services (NASDDDS); Darlynn Thomas, South Carolina Department of Disabilities and Special Needs

A grant-funded partnership conducted a validity assessment of the South Carolina DDSN QA/QI system in the context of the CMS Quality Framework. The presenters will provide an overview and discussion of the methods, selected findings, and implications for statewide assessment of quality of supports for people with intellectual and developmental disabilities.

Room: Augusta–Level Two

TUESDAY, MAY 22

1:45 pm–3:00 pm

Plenary Session on Housing

From Your Facility to My House—Ownership and Control of Housing by People with Disabilities

Moderator: Joanna Pierson, PhD

Derrick Dufresne, Community Resource Alliance, St. Louis, MO, and Institute on Public Policy for People with Disabilities, Springfield, IL;

Bob Laux, Wild River Consulting Group, Bethel, ME;

Mark Straka, Community Access Unlimited, Elizabeth, NJ

Historically, housing and supports for people with disabilities have been combined; where an individual lived determined the level of supports he or she was given. Best practice now requires the separation of housing and supports. In other words, agencies that own housing should not provide services for those they support. This emerging philosophy now makes possible the dream of home ownership and control of housing by people with disabilities. The presenters will highlight real examples of success, options, and possibilities for homeownership, and will discuss strategies for developing integrated, affordable housing owned and controlled by people with disabilities.

Room: Capitol North/Center–Level One



Derrick Dufresne



Bob Laux



Mark Straka

12:15 pm–1:45 pm

Exhibit Hall with Poster Presentations

SPECIAL THEME SESSION

3:15 pm–4:45 pm

Use of the Supports Intensity Scale (SIS) to Determine Resource Allocation

Moderator: Michael Wehmeyer, PhD

Use of the SIS to Determine Resource Allocation

Jon Fortune, Lisa Weber, Donald Severance, Stephen Hall, Christine Hammond

As the need for an equitable determination of individual consumer budgets increases and the requirements for more transparent systems of funding intensify, the Supports Intensity Scale (SIS) is increasingly regarded as a possible instrument to assist in resource allocation. The speakers will share strategies for using the SIS in resource allocation.

Utilizing an Enhanced Version of the Supports Intensity Scale with Direct Links to Individual Supports Planning

Alan Tribble, MEd, Coordinator of Eligibility and Behavioral Supports; Steven M. Wrigley, CPM, Statewide Crisis Systems Administrator; Robert Downing, PhD, Research Administrator

Three additions have been built into AAIDD's standard SISOnline, maximizing the practical application of the SIS for individual planning. In addition, a comprehensive individual supports planning process has been developed based on the principles of Person-Centered Planning and designed to meet Medicaid requirements. Participants will learn how the process is further enhanced by an automated case management system that links the SISOnline data to the supports plan.

Supports Intensity Scale within a Consumer-driven Approach: Exploratory Study of Caregiver and Client Perspectives

Claudia Claes, University College–Ghent University; Geert Van Hove, Ghent University, Department of Orthopedagogics; Stijn Vandeveld, University College–Ghent, Department of Social Work and Welfare Studies; Jos van Loon, Ghent University; Patriek Prinsie, Huize Tordale

Studies report disagreements between self-reports and caregiver responses on several issues related to support need. The presenters will explore the extent to which caregivers' and clients' perspectives coincide on the issue.

Room: Capitol South–Level One

SPECIAL THEME SESSION

3:15 pm–4:45 pm

Choice, Control, and Fairness: How Can We Do It?

Moderator: Sheryl Larson, PhD

Why Bother with Support Coordinators if We Can All Have Support Brokers?

Joanna Pierson, PhD, The Arc of Frederick County

What is the role of support coordinators now that there are support brokers? What do people who want supports and services and their families need that a coordinated effective system of support coordinators can provide and that individually selected support brokers may not be able to provide? This session will explore those questions and more.

Utilizing Support Brokerage as a Component of a Comprehensive Approach to Supports Coordination

Luchara Sayles Wallace, MEd, Beach Center on Disability, University of Kansas

With support brokers, individuals have greater autonomy, choice, and control over their supports and services. The speaker will share the results of a qualitative study investigating the roles and responsibilities of support brokers in building the community life envisioned by the individual.

Using the Concept of At-Risk in Assessing Access to Supports in Alberta, Canada

Donovan Tymchyshyn, Nancy Sharara, and Annalea Sordi, The Vocational and Rehabilitation Research Institute

Assessing risk is integral to determining which supports individuals with developmental disabilities should access and how urgent the need is for the support. This presentation will discuss the intake process with regard to risk assessment as examined in the literature and in the practices of the Persons with Developmental Disabilities Regional Boards of Alberta, Canada.

Offenders with Intellectual Disabilities in England and the United States: Comparison of Issues, Services, and Outcomes

Bruce Williams, PhD, South Central Los Angeles Regional Center

The UK and the US criminal justice systems and intellectual disability service systems address the issues that affect fairness of treatment of offenders with intellectual disabilities differently. Topics will include implementation of laws restricting police interrogations, cooperation between criminal justice and service provider organizations, and public perceptions of criminality and intellectual disability.

Room: Athens–Level Two

SPECIAL THEME SESSION

3:15 pm–4:45 pm

Quality Education, Supporting Students, Families, and Teachers

Moderator: Susan Copeland, PhD

Supporting Family Participation in the Planning for Inclusion of Young Students with Intellectual Disabilities in Regular Education Programs

John Filler, PhD, Jeff Gelfer, and Catherine Lyons, Med, University of Nevada, Las Vegas, and Yaoying Xu, Virginia Commonwealth University

The presenters will emphasize collaborative planning and family participation in the development of adaptations and accommodations to meet the educational needs of toddlers and preschool age children with intellectual disabilities in typical preschool/kindergarten settings.

Family Assessment Portfolios: Using Technology to Give Families a Voice

James Thompson, PhD, Illinois State University

Family Assessment Portfolios (FAPs) are scrapbooks, web-based profiles, and movies that families create to introduce their children to educators, establish good communication between home and school, and influence planning for educational services and individualized supports. Participants will learn about guidelines for content and procedures for creating effective FAPs.

Identifying Indicators of Teacher Quality Among Secondary Special Education Teachers: Implications for Effective Practices During Transition

Mary Morningstar and Sungjik Bae, University of Kansas

The presenters analyzed demographic data from a national sample of secondary teachers and transition specialists to identify high quality secondary special education teachers. They will share the results of the study, which confirm that certain demographic variables contribute to high quality secondary special education teachers who are likely to employ effective transition strategies that lead to post-school success.

Room: Augusta–Level Two

SPECIAL THEME SESSION

3:15 pm–4:45 pm

Real Community Inclusion: Is It Possible?

Moderator: Rufus Britt

Access to Community Settings for Persons with Different Degrees and Types of Disabilities

Sarah Taub and Giuseppina Chiri, Human Services Research Institute; Roger Stancliffe, PhD, Charlie Lakin, PhD, and Robert Doljanac PhD, University of Minnesota

This presentation sheds light on the relationship between service outcomes and specific disability characteristics. The presenters also will discuss the implications for public policy that will ensure equal access to supports for people with all types of degrees of disability.

Agency Factors that Increase Community Participation, Relationships, and Socially Valued Roles

Angela Amado, PhD, Human Services Research and Development Center

Real community inclusion depends on a number of factors, especially provider agency structures that support inclusion and relationships. The speaker will present findings from a five-year project with two large residential services agencies focused on identifying agency factors that influence inclusion, that provide training and technical assistance to address those factors, and that increase community membership and relationships

How Effective Is Person-Centered Planning? A Review of the Research

Steve Holburn PhD and Christine Cea, PhD, New York State Institute for Basic Research in Developmental Disabilities

Learn the outcomes of systematic applications of various person-centered planning approaches. The presenters also will share challenges in implementing person-centered planning and measuring the integrity and outcomes of the intervention, as well as implications of the research findings.

Room: Macon–Level Two

SPECIAL THEME SESSION

3:15 pm–4:45 pm

School Inclusion: Innovations and Outcomes

Moderator: Amy Hewitt, PhD

Next Chapter Book Club: A Community Literacy Program for People with Intellectual Disabilities

Tom Fish, PhD, Jillian Ober, Paula Rabidoux, and Vicki Graff, Ohio State University Nisonger Center

The Next Chapter Book Club (NCBC) program creates opportunities for adolescents and adults with intellectual abilities to improve literacy skills, build social connections, and be included in the community. The program incorporates a variety of literacy, social, and community inclusion techniques for adolescents and adults with a wide range of skills.

Are We Making Progress in Including Students with Intellectual Disabilities in Regular Education Classrooms?

Philip Smith, EdD, Eastern Michigan University

Little progress has been made in including students with intellectual abilities in regular classes. Using historical and current federal data, the presenter will examine the statistics about students with intellectual disabilities who are

fully included in regular education classes. He also will address research, policy, and advocacy issues.

Learning Outcomes of a Culturally Sensitive Intervention on Students with Mild Disabilities from Diverse Backgrounds

Smita Mehta, PhD, University of North Texas

A culturally sensitive intervention was implemented to improve the academic survival of five culturally and linguistically diverse students with mild disabilities in general education classrooms. This session will present the results of the intervention, which showed an improvement in the active engagement for all students, but counterproductive behavior by the teacher.

Cutting Edge Research-Based Practices for Supporting PreK-12 Students Through School District/University Partnerships

Kelley Peters, PhD, University of New Mexico; Debi Hines, Albuquerque Public Schools; Public school educators and university personnel will describe a school district-higher education partnership that facilitated systems-level changes in supporting students with intellectual or developmental disabilities in the least restrictive environment. Presenters will use real-life examples to explain research-based practices in direct instruction, differentiation, transition and peer supports, self-advocacy, and teacher preparation.

Room: Valdosta-Level Two

4:45 pm-5:45 pm
Interactive Poster Presentations
Exclusive time with presenters

See page 21 for a list of Poster Presentations.

Room: Georgia Hall-Level One

5:45 pm-7:30 pm
Exhibit Hall Welcome Reception

Sponsored by:
AAIDD Southern Region and the Georgia Chapter

Room: Georgia Hall-Level One

WEDNESDAY, MAY 23

Registration
8:00 am-4:00 pm

Exhibit Hall Open and Interactive Presentations

See page 21 for a list of Poster Presentations

10:15 am-10:45 am
Coffee Break

Room: Georgia Hall-Level One

7:00 am-8:00 am

DABS Committee

Presiding: Marc Tassé, PhD

Room: Atlanta 3-Level One

7:00 am-8:00 am

Health and Wellness Action Group (HWAG) Breakfast Meeting

Presiding: Barry Martin, MD, and Lee Barks, PhD

Room: Atlanta 2-Level One

8:00 am-8:30 am

Reflection Times: "Integrating Faith and Professional Practice: A Time for Reflection and Meditation"

Room: Atlanta 5-Level One

8:00 am-9:00 am

Exhibit Hall and Poster Presentations

Complimentary Continental Breakfast
Room: Georgia Hall-Level One

8:00 am-9:00 am

Archives and Historic Preservation Committee Open Meeting

(members and non members are invited)

Presiding: Michael Dillon, EdD

Room: Atlanta 4-Level One

8:00 am-9:00 am

Legal Process and Advocacy Division

Presiding: Kelley Peters, PhD

Room: Atlanta 3-Level One

8:00 am-9:00 am

Editorial Advisory Board

Presiding: Bruce Appelgren

Room: Atlanta 1-Level One

8:00 am-9:00 am

Psychology Division

Presiding: Marc Tassé, PhD

Room: Athens-Level Two

8:00 am-5:00 pm

Speaker Ready Room

Room: Georgia 14-Level One

WEDNESDAY, MAY 23

10:45 am-12:15 pm

Special Session Training Opportunities with the Supports Intensity Scale (SIS)

In this information sharing session, AAIDD Senior Trainers Michael Chapman and Natalie Ihli will describe the phases of training offered on the Supports Intensity Scale that have benefited hundreds of professionals. Learn how they ensure that the SIS interviews and subsequent scores are reliable and useful for states, organizations, and people with intellectual disabilities.



Room: Atlanta 1-Level One

WEDNESDAY, MAY 23

9:00 am–10:15 am

**Plenary Session on Health
Health Protection for People with
Intellectual and Developmental Disabilities**

Moderator: *Carolyn Graff, PhD, RN*

Julie Louise Gerberding, MD, MPH

Director, Centers for Disease Control and Prevention, Atlanta, GA

Rich Besser, MD

*Director of Coordinating Office of Bioterrorism
and Emergency Preparedness*



As one of the 13 major operating components of the U.S. Department of Health and Human Services, the Centers for Disease Control and Prevention is at the forefront of public health efforts to prevent disabilities, injuries, infectious and chronic diseases, workplace hazards, and environmental health threats. The CDC is

globally recognized for its research, investigations, and action oriented approach to applying research and research findings to improve the daily lives of citizens. In this session, Dr. Gerberding, Director of the CDC, will be joined by another expert to discuss the CDC's efforts to promote health; prevent disabilities, diseases, and injuries; and assist in emergency preparedness for persons with disabilities.

Room: Capitol North/Center–Level One

10:00 am–1:15 pm

Exhibit Hall Open

Coffee Break 10:15 am

Room: Georgia Hall–Level One

SPECIAL THEME SESSION

10:45 am–12:15 pm

**Prescription for Quality Health Care:
Collaboration!**

Moderator: *Lee Barks, PhD*

Teaching Health Care Professionals about Health Needs of Individuals with Disabilities

Barry Martin, MD, Metro Community Provider Network; Carolyn Graff, PhD, University of Tennessee Health Science Center; Paula Minihan, Tufts University School of Medicine

One of the barriers to good health care for individuals with disabilities is the fact that health professions education programs do not provide exposure to individuals with disabilities. The presenters will identify institutions where such training is happening and discuss nationwide efforts to create curricula for health profession schools and training programs.

Providing Current Knowledge to Health Professionals

Wendy Nehring, RN, PhD, Rutgers College of Nursing

Pre-licensure education often lacks instruction in knowledge, skills, and practical experiences in the care of persons with intellectual and developmental disabilities. This presentation will provide information about current literature, organizations, and initiatives to promote education in the field after graduation—especially for health professionals who do not have easy access to a university.

In the Same Boat: Pulling Together

Alya Reeve, MD, and Jill Ryan, PhD, University of New Mexico

Integrating information from a variety of sources, systems, and agendas that may support healthy lifestyles and healthy decisions requires ongoing collaboration among individuals with intellectual disabilities, their teams, and professionals who provide health-related supports. The presenters will offer case materials that illustrate successful collaboration toward sustained health and wellness.

Multidisciplinary Consultative Therapeutic Supports Enable Quality Living for Adults with Intellectual and Developmental Disabilities

Catherine Gardner, Cynthia Epstein, Karym Hawrylak, and Bonnie Lisbona, Occupational Therapy Consultants, Inc

Enabling adults with intellectual and developmental disabilities to achieve quality living often requires professional support from occupational therapists and speech language pathologists who have limited availability in community settings. The presenters will outline a community-based consultation model and role delineation process that enables these providers to function as key collaborative team members.

Room: Athens–Level Two

SPECIAL THEME SESSION

10:45 am–12:15 pm

Health Care: Supporting Vulnerable People

Moderator: *Steve Eidelman*

Expansion of an Advocacy Program for People with Disabilities at a Safety Net Hospital

Richard Dwyer, Mary Cerreto, PhD, Joanne Wilkinson, MD, Chris Andry, PhD, Lisa O'Connor, and Larry Culpeper, MD, Boston University Medical Center; Marc Emmeric, MD, Massachusetts Medical Services

A successful advocacy support system for inpatients with intellectual, cognitive, and/or communication disabilities at Boston Medical Center lead to an outpatient model now being piloted to support people with intellectual disabilities. The presenters will discuss the goal of the program: to improve health care access, increase preventative health care testing and continuity of care, and provide training for health care professionals working with people with intellectual disabilities.

Osteoporosis and Fracture Risk: Putting Cutting Edge Research into Practice

Pixie Plummer, MD, and Sandra Friedman, MD, Children's Hospital Boston

Many individuals with intellectual and/or developmental disabilities are at special risk for osteoporosis. This session will provide an in-depth review of bone health with attention to risks, innovative screening and diagnostic techniques, treatment, and research for individuals with intellectual or develop-

mental disabilities. The presenters will share new information and resources about cutting edge practices.

Health Behaviors and Health Care Services for Women of Color with a Child with Developmental Disabilities

Sandy Magaña, PhD, Waisman Center, University of Wisconsin–Madison; Matthew Smith, Washington University, St. Louis

Research indicates that older Latina and Black American mothers caring for a child with a developmental disability are at greater risk for poor health than their peers. This session examines the role of health behaviors, health care utilization, and access in older Latina and Black American mothers of children with a developmental disability.

Room: Augusta–Level Two

SPECIAL THEME SESSION

10:45 am–12:15 pm

Spiritual Communities Offer Support and Moral Guidance

Moderator: *Hank Bersani, Jr, PhD*

Benedictions: Addressing the Spiritual Tasks in Aging and End of Life Time Periods

Bill Gaventa, Jr, MDiv, The Elizabeth M. Boggs Center on Developmental Disabilities

Why do older people become more spiritual? This session will address some of the spiritual tasks of aging and moving toward death, and ways that service providers and staff can help adults with developmental disabilities address the core questions that face everyone as they move into the final stages of life.

Participatory Personhood: A Role for Persons with Disabilities

David Coulter, MD, Harvard Medical School

The philosophical concept of personhood has been used to devalue persons with disabilities. The speaker will present a new approach: participatory personhood that explores the ways persons with disabilities play important roles in the community and emphasizes how, when practiced, we recognize persons with disabilities as valued citizens in our communities.

The Role of Religious and Moral Perspectives in Biotechnology and Genetic Dialogues

Matthew Stowe, JD, Beach Center on Disability; Bill Gaventa Jr, MDiv, The

Elizabeth M. Boggs Center on Developmental Disabilities

The potential ethical, legal, and social implications of new human genetic research and biotechnology pose fundamental questions related to our society's definition of life, autonomy, individual worth, normalcy, and social justice. This presentation will address the need for and role of religious and moral perspectives on genetic science in our search for answers to these issues.

Family Support Grows out of a Healthy Graft into the Family of God (Congregations)

Jim Lewis, Institute on Abundant Living

The Black Walnut tree has a strong root system but yields poor quality fruit. The English Walnut has a weak root system but yields good quality fruit. For centuries, farmers have grafted English Walnuts into Black Walnuts to produce a strong tree that bears good, healthy fruit. The presenter will draw on this analogy to show that family support comes from being grafted into a large and fruitful faith-based tree.

Room: Macon–Level Two

SPECIAL THEME SESSION

10:45 am–12:15 pm

Behavioral Health Interventions: Methods and Tools

Moderator: *Marc Tassé, PhD*

30 Years with No Physical Intervention

George Suess, The Arc of Delaware County, New York

The Arc of Delaware County (NY) has been committed to a proactive philosophy and positive approach for more than 30 years and has a board-level policy that prohibits the use of physical intervention. The presenter will emphasize the importance of caring relationships, praise and reinforcement, engagement, and training of direct service professionals.

Investigating Issues Related to Behavior Plan Development and Implementation: Results from a Multi-Year Research Project

Bonnie Kraemer, PhD, San Diego State University; Clayton Cook, UC Riverside; Diana Browning Wright, Positive Environments, Network of Trainers (PENT); Roy Mayer and Michele Wallace, California State University, Los Angeles
 Researchers from the California Department of Education's Positive Environ-

ments Network of Trainers undertook a multi-year research project to assess issues related to behavior intervention plan development and implementation across California. Participants will learn about the Behavior Support Plan Quality Evaluation Guide and evidence-based rating instrument used to facilitate the substantive quality of behavior intervention.

Tools to Optimize Behavioral Health Outcomes

Dina McFalls and Carol Persons, Philadelphia Coordinated Health Care

Presenters will detail tools that have been developed for provider agencies to enhance their ability to provide adequate support, connect support to risk management, and determine the quality of the supports provided.

Health Outcomes for Adults with Developmental Disabilities: Public and Private Grants Leveraging Statewide Systems Change

Duncan Munn, State Agency; Karen Luken, Sarah Somers, and Kathryn Moss, University of North Carolina at Chapel Hill; Anna Johnston, ND Division of Public Health; Bill Milner, Access Dental Care, Inc; Irene Jurzyk, Mountain Area Health Education Center

This session will outline innovations in community-based health and dental services; training of physicians, other health care and direct professionals; outreach; and service system coordination and integration for persons with developmental disabilities. The presenters will discuss the process for translating these experiences into statewide systems change through an interagency approach.

Room: Valdosta–Level Two

SPECIAL THEME SESSION

10:45 am–12:15 pm

Healthy Environments: Self-Advocates Speak Out!

Moderator: *Cathy Ficker Terrill and Laura Abulafia*

Environmental Health and Intellectual Disabilities

Bill DuSold, Beth Terrill, and Joe Meadours

Three self-advocates will address the topic of environmental health, including chemical sensitivity, environmental tobacco smoke, and strategies to get the developmental disabilities community more involved on a legislative level.

**Chemical Policy Reform—
SAFER**

Laura Abulafia, AAIDD Environmental Health Initiative

This session will cover current AAIDD involvement in National Chemicals Policy and will outline what work is being done with the help of AAIDD members to address health concerns regarding harmful chemicals in certain key state governments around the United States.

Environmental Health Risks of People with Developmental Disabilities Living in Community-based Residential Settings

Carolyn Graff, PhD, University of Tennessee Health Science Center

The presenter will provide participants with research findings about residential environmental health threats for persons with disabilities.

Room: Capitol South—Level One

12:15 pm–1:30 pm

AAIDD and the Academy Student Lunch and Conversation Hour

An opportunity for informal and “student-friendly” collegial interactions.

All students are welcome!

Please get your lunch ticket at the registration desk by Wednesday at 10:00 am.

Room: Atlanta 5—Level One

SPECIAL THEME SESSION

3:00 pm–4:15 pm

Implementing the Supports Intensity Scale (SIS) in Three States

Moderator: Michael Chapman

Moving the Money: Individual Development Accounts for Citizens with Developmental Disabilities

Stephen Hall, PhD, State of Georgia DHR/DMHDDAD

Participants will learn how to shift from funding programs, services, and buildings to investing in impact services and supports that significantly improve the lives of persons with developmental disabilities. New Medicaid Waivers and the AAIDD supports Intensity Scale are the foundation for these Individual Development Accounts.

Developing a Statewide System for Individualized Planning and Resource Allocation Using the Support Intensity Scale

WEDNESDAY, MAY 23

1:30 pm–2:45 pm

**Plenary Session on Assessment
The Respective Role and Importance of People’s
Adaptive Skills and Individual Support Needs**

Moderator: Wayne Silverman, PhD

Marc J. Tassé, PhD, FAAIDD

Florida Center for Inclusive Communities—UCEDD, University of South Florida;

James LeVelle, PhD

Louisiana Office for Citizens with Developmental Disabilities, Department of Health and Hospitals.



Understanding the differences in an individual’s adaptive skills and intensity of support needs is critical.

Adaptive skills play an important role in determining eligibility for services but are only one piece of the very complex

puzzle of understanding someone’s support needs. Understanding

and assessing an individual’s support needs is based on a comprehensive understanding of an individual and not merely what he or she can do. The presenters will discuss the importance of the Association’s leadership role in the field of adaptive functioning and support needs and the distinction and relative importance of each in planning services and supports. They will show how these two constructs play a role in the lives of individuals with intellectual and related developmental disabilities.

Room: Capitol North/Center—Level One

James LeVelle, PhD, and Scott Meche, Louisiana Office for Citizens with Developmental Disabilities

This session will focus on how the State of Louisiana is adopting the Support Intensity Scale and the Louisiana PLUS for individualized planning and resource allocation, including training, assessments, validation, and statistical analysis. Once the adoption is complete, the result should be a seamless system that supports self direction and fiscal accountability.

Implementing Standardized Assessment in Washington State

Linda Rolfe, John Stern, and Lisa Weber, Washington State DSHS/DDD

Washington State has moved away from a clinically based approach to service planning and rate setting toward standardized assessments. The speakers will share their experiences implementing a full assessment, overcoming the challenges of selecting a tool that would meet all of its needs, and instituting standardized assessment within a culture that strives for individualized supports.

Room: Capitol South—Level One

SPECIAL THEME SESSION

3:00 pm–4:15 pm

Adaptive Behavior: Assessment, Diagnosis, and Supports

Moderator: Mark Yeager, PhD

Assessment of Adaptive Behavior and the Diagnosis of Intellectual Disabilities

Marc Tassé, PhD, University of Florida; Giulia Balboni, PhD, University of Padua Italy; Robert Schalock, PhD, Schalock & Associates; Sharon BorthwickDuffy, PhD, University of California Riverside; Robert Horner, PhD, University of Oregon—College of Education; Hank Bersani, Jr., PhD, Western Oregon University; Julia de Valenzuela, PhD, University of New Mexico—College of Education; Scott Spreat, EdD, Wood Services Inc; David Thissen, PhD, University of North Carolina—Department of Psychology; Keith Widaman, PhD, University of California at Davis Department of Psychology; Dalun Zhang, PhD, Texas A&M University

The presenters will review the main issues related to defining and assessing adaptive behavior. They also will discuss some of the relevant issues related to diagnosing intellectual abilities as well

as a new diagnostically focused assessment instrument for measuring adaptive behavior across the age span.

Utilizing a Systems-based Approach to Clinical Assessment: A Model for Support Service Provision

Lara Head, PhD, Waisman Center, University of Wisconsin, Madison; Carolyn Graff, PhD, University of Tennessee Health Science Center; Heather Hall, RNC, University of South Alabama; Laura Murphy, EdD, Boling Center for Developmental Disabilities; Leonard Abbeduto, PhD, Waisman Center, University of Wisconsin-Madison

A clinical assessment process is underutilized as a venue for determining the support needs of families caring for a child with a developmental disability. Panel members will discuss the importance of using a systems-based approach to assessment, identifying instruments and procedures that target individual and family characteristics, and translating findings into interventions.

Room: Athens-Level Two

SPECIAL THEME SESSION

3:00 pm-4:15 pm

Sexuality: Promoting Healthy Relationships

Moderator: Alya Reeve, MD

Challenges in Socialization/ Sexuality Education: Providing Supports to Couples Who Want to Have Sex

Jill Ryan, PhD, New Mexico Department of Health, Developmental Disabilities Supports Division; Mark Gordon, Developmental Disabilities Supports Division, Developmental Disabilities Planning Council

Making the strongest connection possible between their personal values and making good choices about relationships, especially intimate ones, is the guiding principle of the new socialization/sexuality education programs the presenters will discuss. They also will summarize the outcomes of almost two years of the program.

Couple Therapy for People with Intellectual Disabilities: A Positive and Effective Treatment Model

Dale Munro, MSW, Regional Support Associates

There is little literature about counseling methods with couples with intellectual disabilities. The speaker will share an effective model of couple treatment that takes into account the subtleties inherent in the field. He will discuss assessment, mediation, and treatment strategies.

Room: Augusta-Level Two

SPECIAL THEME SESSION

3:00 pm-4:15 pm

Emergency Preparedness: Getting Ready for the Next Disaster

Moderator: Sid Blanchard

Emergency Management and People with Disabilities: Assessing States' Readiness

Patricia Salmi, PhD, University of Minnesota; Chas Moseley, EdD, National Association of State Directors of Developmental Disability Services

A new self-assessment tool is being developed to help state agency officials evaluate the extent to which their existing preparedness plans are able to address the unique characteristics of individuals receiving support through publicly funded developmental disability programs.

Surviving Katrina and Rita: New Orleans Direct Support Professionals' Experiences

Sheryl Larson, PhD, Research and Training Center on Community Living, University of Minnesota; Amy Hewitt, PhD, Jerry Smith, Tracy LaLiberte, PhD, Institute on Community Integration, University of Minnesota

Direct support professionals (DPSs) provide daily support for people with disabilities, but what happens in the face of a disaster? This session will describe the experiences and personal stories of DSPs from the New Orleans area who provided support to individuals with disabilities before, during, and after Hurricanes Katrina and Rita.

Room: Macon-Level Two

SPECIAL THEME SESSION

3:00 pm-4:15 pm

Supporting the Next Generation of Leaders

Moderator: David Rotholz, PhD

Supporting Professional Growth and Nurturing Future Leaders: Initiatives of the AAIDD Ad Hoc Committee on Student and Junior Member Recruitment and Retention

Karrie Shogren, PhD, University of Texas at Austin; Amy Drahota, University of California, Los Angeles; Anna Esbensen, PhD, Wasiman Center-University of Wisconsin; Susan Haverkamp, PhD, Florida Center for Inclusive Communities, UCEDD; Nancy Miodrag, McGill University; Louise Lord-Nelson, PhD, Reliable Alliance in Special Education Inc; Mian Wang, PhD, Rowan University; Shelley Watson, MEd, University of Alberta

Members of the Ad Hoc Committee will provide an overview of ongoing initiatives to foster the involvement and representation of students, recent graduates, and junior faculty/executives within AAIDD, including ways that junior and senior members can get involved in these initiatives.

Preparing the Next Generation of Leaders for Organizations Providing Services, Supports, Advocacy, and Oversight

Steven Eidelman, MSW, and Nancy Weiss, MSW, University of Delaware

Effective leadership is critical to the quality of supports individuals with disabilities receive. Participants will learn about the National Consortium on Developmental Disabilities and the importance of preparing the next generation of leaders to provide services, advocacy, and oversight.

Room: Valdosta-Level Two

WEDNESDAY, MAY 23

2:45 pm-4:15 pm

Terminology and Classification Manual OPEN FORUM

Don't miss this critical opportunity for the membership to provide input to the committee working on the *Terminology and Classification 2009-10 Manual*.

Room: Atlanta 3-Level One

WEDNESDAY, MAY 23

4:30 pm–5:30 pm

Presidential Address

The Past Is Prologue

By Hank Bersani, Jr., PhD, FAAIDD
AAIDD President



Introductions:
Val Bradley, President,
Human Services Research
Institute

Room: Capitol
North/Center–Level One

Awards Reception
Entertainment provided by
the Bluegrass Duo

Tom Morgan and Lynne Haas share their love of traditional music with an eclectic mix of Appalachian, Celtic, and Bluegrass instrumentals and ballads.

Over the past 50 years, Tom has played with top bluegrass groups including Curly Fox, Bill Monroe, and Country Gentleman and appeared with Red Allen & Frank Wakefield, Stanley Brothers and Buzz Busbee. Tom cataloged a collection of old time and bluegrass songs, is a (Smithsonian) recognized luthier (builder and repairer of string instruments), and is one of the founders of the premier Bluegrass Unlimited Magazine. Tom hails from Morgan Springs, Tennessee, sings lead and tenor, and plays guitar, mandolin, and bass.

Lynne is from North Georgia and has performed with Tom since 1999. She sings lead and alto and plays autoharp and mountain dulcimer. Musically trained in piano and organ, Lynne has lifelong interests in choirs and glee clubs. She enjoys teaching young people and especially serving as a workshop leader for Girl Scouts. Lynne has led acoustic music workshops in North Carolina, Tennessee, and Georgia.

Their new CD, “Celebrating the Traditions of Music Shared” by Tom Morgan and Lynne Haas, may be available for signing and purchase at the AAIDD Annual Conference.

WEDNESDAY, MAY 23

5:30 pm–6:30 pm

International Awards Ceremony

2007 AAIDD
Award Recipients

Full Community Inclusion Award
Robert S. Laux

International Award
Wil H. Buntinx, PhD

Media Award
Alice Elliott
Diana Braun
Kathleen Conour

Service Award
Marc J. Tassé, PhD

Special Award
James R. Thompson, PhD

Student Award
Nina I. Zuna

Henri Nouwen Award
Nancy L. Eiesland, PhD

Robert Guthrie Award
Claude Sansaricq, MD, PhD

Awards Reception

6:30 pm–7:30 pm

Room: Capitol North/Center–Level One

2007 NEW LEADERSHIP

BOARD OF DIRECTORS

Joanna L. Pierson, PhD
Vice President

James F. Gardner, PhD
Secretary-Treasurer

Karrie A. Shogren, PhD
Member-at-Large

2007 FELLOWS

William E. MacLean, PhD
Stacy G. Miller

Susan B. Palmer, PhD
James R. Thompson, PhD

Discover why professionals are using the Supports Intensity Scale (SIS)

to plan and implement quality services for people with intellectual disabilities.

Unique, needs-based assessment scale now adopted by several U.S. states and providers in other countries!

Why professionals are using SIS

- SIS provides an objective measure to discuss and quantify a person's support needs.
- Assessment results identify practical ways to support an individual.
- Reliable and fair results help develop precise individualized plans.
- Assessment scores justify and clarify roles of staff within organizations.

How families benefit from SIS

- For the first time, service decisions are based on needs, not deficits.
- The SIS interview is positive, and multiple respondents can provide feedback.
- Comprehensive discussion opens up possibility for activities never before considered.
- SIS allows a person to live a quality life of his or her own making.



American Association
on Intellectual and
Developmental Disabilities



Now available in print, CD-ROM, and SISOnline on the web!

Here's what providers are saying about SIS:

"The SIS is comprehensive, and provides an easy-to-read and clear set of expectations for those involved with providing supports."

— **Regis Obijiski**,
Executive Director, New Horizons
Resources, Inc.

"The Supports Intensity Scale is one of the most significant tools to come along in my entire 35 years of service in the disability field, and I cannot say enough about the critical need for such an instrument."

— **Ron Wisecarver**,
President/CEO, Peoria ARC

Ask about SIS training workshops at books@aidd.org.
Discover more at www.siswebsite.org!

Order SIS now!

PHONE: 301-604-1340
FAX: 301-206-9789
WEB: <http://bookstore.aidd.org>
MAIL: AAIDD Publications
P.O. Box 25
Annapolis Junction, MD 20701-0025

No. 250 SIS Manual/25 Interview forms . . . \$125.00
No. 251 25 Interview forms . . . \$38.75
No. 252 100 Interview forms . . . \$147.25
No. 253 SIS Manual only . . . \$95.00
No. 254 SIS CD-ROM . . . \$325.00

Email books@aidd.org for pricing on web-based SISOnline.
Mention Priority Code: AD7

THURSDAY, MAY 24

Registration

8:00 am–2:30 pm

7:00 am–8:00 am

Emergency Preparedness & Hurricane Katrina Action Group

Presiding: Wendy Nehring, PhD

Room: Atlanta 3–Level One

7:00 am–8:00 am

SIS Sales Team

Presiding: Bruce Appelgren

Room: Atlanta 2–Level One

7:00 am–8:00 am

Social Work Division Meeting

Presiding: Barbara Hanley, PhD

Room: Atlanta 4–Level One



THURSDAY, MAY 24

9:00 am–12:00 noon

**NADD/AAIDD Symposium I
Diagnostic Manual–Intellectual Disability (DM–ID)**

Robert J. Fletcher, DSW, ACSW, FAAIDD

National Association for the Dually Diagnosed, Kingston, NY

Chrissoula Stavrakaki, MD, PhD

University of Ottawa, Ottawa, Ontario, Canada

The Diagnostic Manual–Intellectual Disability (DM–ID): A Textbook of Diagnosis of Mental Disorders in Persons with Intellectual Disability, developed by the National Association for the Dually Diagnosed (NADD), in association with the American Psychiatric Association (APA), is a diagnostic manual designed to be an adaptation of the DSM-IV-TR. Grounded in evidence-based methods and supported by the expert-consensus model, the DM–ID offers a broad examination of the topic, including a description of each disorder, a summary of the DSM-IV-TR diagnostic criteria, a review of the research and an evaluation of the strength of evidence supporting the literature conclusions, a discussion of the etiology and pathogenesis of the disorders, and adaptations of the diagnostic criteria for persons with ID.

A shorter volume, *Diagnostic Manual–Intellectual Disability (DM–ID): A Clinical Guide for Diagnosis of Mental Disorders in Persons with Intellectual Disability* has been abridged for clinical usefulness. It focuses on issues related to diagnosis in people with ID, the limitations in applying DSM-IV-TR criteria to people with ID, and adaptation of the diagnostic criteria.

The goal of both volumes is to facilitate a more accurate psychiatric diagnosis of people with ID. Chapters in the DM–ID cover both special issues (i.e., assessment and diagnostic procedures and presentations of behavioral phenotypes of genetic disorders) as well as the individual DSM-IV-TR categories. For each disorder, descriptive text and details of how to apply diagnostic criteria, as well as tables of adapted diagnostic criteria, are included.

The presenters will review the major features of the DM–ID, including the application of diagnostic categories and use of adapted diagnostic criteria. Particular attention will focus on several diagnostic categories that are commonly identified in persons with intellectual disabilities.

Cost: \$79 AAIDD and NADD members; \$99 non-members

Room: Georgia 13–Level One

THURSDAY, MAY 24

2:00 pm–4:00 pm

**NADD/AAIDD Symposium II
Mental Health Problems in Children/Adolescents:
Can These Be Prevented or Ameliorated?**

Ann R. Poindexter, MD, FAAP, FAAIDD

Health Care Consultant, Conway, AR

Issues related to early diagnosis of mental health disorders in children and adolescents, including both developmentally disabled and general population individuals, will be discussed. The presenter will outline recent research in the prevention of these disorders and amelioration of severity through early diagnosis, and will project future directions. She also will describe various tools to facilitate diagnosis of mental health conditions in children and adolescents, particularly those designed for primary care providers and school settings. The presenter also will share recent research in the prevention of these disorders and outline probable general directions for the future. Time will be allowed for discussion.

Cost: \$79 AAIDD and NADD members; \$99 non-members

Room: Georgia 13–Level One

THURSDAY, MAY 24, 2007

9:00 am–4:30 pm

Religion and Spirituality Division Retreat

Deep and Wide: A Retreat Day Exploring Theological Issues and Models of Devel- oping Interfaith Supports

Nancy Eiesland, PhD, Candler School of Theology, Emory University, Atlanta, GA; **Mark Crenshaw**, Interfaith Disabilities Network, Atlanta, GA

Location: First Baptist Church of Decatur, Georgia, 308 Clairmont Ave., Decatur, GA

This one-day workshop/retreat provides an opportunity for members of the Religion and Spirituality Division of AAIDD and other AAIDD members to meet, network, and reflect with people involved in ministries with people with disabilities and their families in the wider Atlanta area.

Nancy Eiesland is associate professor of sociology of religion at the Candler School of Theology, Emory University, and author of *The Disabled God, Human Disability and the Service of God*, and numerous articles and chapters on disability theology. She is currently working on a project that explores theology of disability and mothers with disabilities. Dr. Eiesland will present some of the themes of her writing and current research and thinking, and help us all reflect on the theological dimensions of our work.

Mark Crenshaw coordinates an area-wide interfaith, interagency program in ministries and faith-based supports in the Atlanta area. He will talk about their projects and some of the lessons learned in working on an interfaith, interagency basis with congregations, agencies, and advocacy groups.

There will plenty of time for discussion, sharing, and networking among participants. AAIDD members who are doing presentations at the AAIDD Conference also will bring summaries and resource materials. The day provides a valuable opportunity for participants at a national conference and people local to the Atlanta area to network. The retreat will be followed by dinner at a local restaurant.

Dinner at 6:00 pm

Location: Mary Mac's Tea Room, 224 Ponce De Leon Avenue, Atlanta, GA

Morning Workshops

ONSITE FEE \$65

9:00 am–12:00 noon

(#01-07) 2nd Edition of the AAIDD Positive Behavior Support Training Curriculum: Overview and Practical Methods for Successful Implementa- tion

David Rotholz, PhD, University of South Carolina; **Dennis Reid, PhD**, Habilitative Management Consultants, Inc.

The AAIDD Positive Behavior Support Training Curriculum was revised for 2007. The new 2nd edition of the curriculum includes improvements based on eight years of use by authors, editors, and others who provided constructive suggestions for revision. This workshop, presented by the lead author and editor of the curriculum, provides key information on the content of the curriculum, training format, and how best to implement it for supervisors and direct support professionals. Feedback collected from hundreds of participants will be included in this presentation and integrated into the implementation recommendations.

Room: Georgia 14–Level One

9:00 am–12:00 noon

(#02-07) A Community-wide Approach to Supporting the Health Care Needs of Individuals with Intellectual Disabilities

Marisa Brown, MSN, Georgetown University

The D.C. Health Resources Partnership was established to improve health care access for individuals with intellectual disabilities in the District of Columbia. The three areas of focus include: (1) identifying and supporting access to appropriate health care services; (2) providing training and targeted technical assistance to individuals, community agency staff, hospital staff, and the District's Mental Retardation and Developmental Disability Administration; and (3) establishing and gathering evidence for best practice models of health care delivery. This workshop will review these strategies and provide suggestions for developing funding mechanisms to support similar efforts in other communities.

Room: Atlanta 1–Level One

9:00 am–12:00 noon

(#03-07) Changing Attitudes, Chang- ing Lives: Supports for Quality Living

Erica Jones, Amy Walker, Krescene Beck, Illinois Voices

Hear the voices of more than 20 people with developmental disabilities whose lives were forever changed through the Illinois Voices initiative. This exciting interactive workshop describes an innovative approach to self-advocacy that redefines best practice. Illinois Voices self-advocates, along with the project director and project coordinator, will guide the audience through the 18-month journey of empowering people with developmental disabilities and service providers to create and sustain environments that support the self-advocacy movement.

Room: Atlanta 4–Level One

9:00 am–12:00 noon

(#04-07) CQL Quality Measures 2005 Accreditation: A Journey to Excellence

Elizabeth Mathis, The Council on Quality and Leadership

The Council on Quality and Leadership (CQL) is an international not-for-profit organization dedicated to the definition, measurement, and evaluation of personal and community quality of life. In May 2005, CQL introduced a new set of measures that evaluate personal quality of life: Basic Assurances[®], Shared Values, Responsive ServicesSM, and Community LifeSM. Accreditation with Quality Measures 2005[®] is one quality strategy associated with these measures. This session will focus on how CQL's accreditation results in an ongoing partnership with organizations to create and implement integrated quality management systems.

Room: Atlanta 5–Level One

9:00 am–12:00 noon

(#05-07) The Supports Intensity Scale (SIS): A Workshop for Users

James Thompson, PhD, Illinois State University

This workshop will familiarize session attendees with the Supports Intensity Scale (SIS). The SIS is intended to be used within a four-component support needs assessment and planning approach—an approach that will be explained during the workshop. The presenter will explain each phase of SIS's development, as well as findings from recent field tests. Additionally, participants will receive explicit instructions on how to administer and score the instrument, and how to interpret results.

Room: Atlanta 2–Level One

Afternoon Workshops

ONSITE FEE \$65

1:00 pm–4:00 pm

(#06-07) Improving Person-Centered Planning through Evaluation

Steve Holburn and Christine Cea,
New York State Institute for Basic Research

In this workshop, the presenters will describe practical evaluation methods for agencies that wish to systematically implement person-centered planning. They will share quantitative and qualitative approaches, emphasizing how the results inform the management and planning team to improve the process. Participants will receive assessment tools that evaluate the integrity of the process, quality of life, organizational effectiveness, person-centered climate in the agency, and participant satisfaction. Participants also will learn how to apply these methods, which will be exemplified as they were applied in various person-centered planning projects.

Room: Atlanta 1–Level One

1:00 pm–4:00 pm

(#07-07) Literacy Instruction for All Students: Supporting the Literacy Learning of Individuals with Moderate or Severe Disabilities

Susan Copeland, PhD and Elizabeth Keefe,
University of New Mexico

This interactive workshop teaches participants research-based strategies to assess and teach literacy skills to individuals with moderate or severe disabilities, including persons with intellectual disabilities, multiple disabilities, or autism spectrum disorders. The session includes discussion, demonstration, and hands-on learning activities related to literacy assessment and instructional strategies in each of the critical components of an effective reading program: phonological awareness and phonics, vocabulary, text comprehension, fluency, and oral language.

Room: Georgia 14–Level One

1:00 pm–4:00 pm

(#08-07) Teaching Socialization/ Sexuality Education to Adults with Intellectual/Developmental Disabilities

Jill Ryan, PhD, *New Mexico Department of Health, Developmental Disabilities Supports Division;*

Mark Gordon, *Developmental Disabilities Supports Division, Developmental Disabilities Planning Council*

The Friends Curriculum teaches skills and habits that promote stability and deepening of relationships that may include intimacy. Skills taught using the Friends Curriculum range from ways to make relationships lively and joyful to becoming familiar with conflict resolution and assertiveness. This workshop presents the methods used in the curriculum, including goals, objectives, strategies, and activities. The presenters also will share samples of curriculum and student work.

Room: Atlanta 2–Level One

1:00 pm–4:00 pm

(#09-07) The Surgeon General's Call to Action to Improve the Health and Wellness of Persons with Disabilities

Marisa Brown, *Georgetown University;*
Eileen Elias, *U.S. Department of Health and Human Services, Office on Disability*

During the past year a broad group of stakeholders from throughout the country participated in planning sessions to develop strategic plans to implement the 2005 Surgeon General's Call to Action to Improve the Health and Wellness of Persons with Disabilities. This session will review the strategies developed and engage participants in planning what they can do at a regional or local level, in collaboration with community partners, to implement some of the strategies.

Room: Atlanta 4–Level One

1:00 pm–4:00 pm

(#10-07) Using Person-Centered Planning to Support Life and Death Decision Making

Leigh Ann Kingsbury, *Arc Services*

This workshop will address the issue of using the core skills and tools of good person-centered planning to support health care and end of life decision making with people with ID and/or DD. The presenter will focus on the process of People Planning Ahead, a practical skill-based method of exploring health care and end of life issues and developing advance directives with people with ID and/or DD.

Room: Atlanta 5–Level One

Two-Day Professional Workshop

May 24 and 25, 2007

(#11-07)

Adults with Intellectual Disabilities Living Inclusive and Self-Determined Lives through Individual Control of Funding and Creative Use of Resources:

"Nuts and Bolts" of Supports to Make it Happen

Ann P. Turnbull, Martha Blue-Banning, Suk-Hyang Lee, Denise Poston, Luchara Sayles Wallace



This interactive two-day workshop will focus on the day-to-day realities of adults with significant intellectual disabilities and the support they need to create a life of full inclusion and participation in the community through individual control of funding, supports, and services. The presenters will address such issues as creating "funding packages" by merging funding streams, asset building, person-centered planning, individual budgets/fiscal intermediaries, support brokerage, and inclusive supports/services, including employment, own housing, housemates and personal assistants, friendships and community inclusion.

Thursday, May 24

9:30 am–5:00 pm
and

Friday, May 25

8:30 am–3:30 pm

Room: Atlanta 3–Level One

Onsite Fee \$125

TUESDAY, MAY 22

10:45 am–12:15 pm

ACADEMY SYMPOSIUM I

Advances in Augmented Communication Interventions for Children with Intellectual Disabilities

Organized by MaryAnn Romski and Rose Sevcik, Georgia State University, Atlanta, GA

Teaching Natural Gestures to Young Children with Deaf-Blindness and Intellectual Disabilities

Nancy Brady, University of Kansas, Lawrence, KS

Graphic Symbol Vocabulary Learning by Children with Intellectual Disabilities

Rose Sevcik, Georgia State University, Atlanta, GA

Parent-Implemented Augmented Language Interventions and Vocabulary Learning by Toddlers with Significant Developmental Delays

MaryAnn Romski, Georgia State University, Atlanta, GA

Discussant: Leonard Abbeduto, Waisman Center, University of Wisconsin-Madison, Madison, WI

3:15 pm–4:15 pm

ACADEMY LECTURE

Family Interactions and Long-Term Adaptation for Families of Children with Intellectual Disabilities

Presented by Frank Floyd, PhD, Georgia State University, Atlanta, GA.

Room: Georgia 13–Level One

4:45 pm–6:00 pm

ACADEMY POSTER SESSION

(in conjunction with AAIDD poster session)

Board #60

Adolescents and Adults with Autism Spectrum Disorders with and without Comorbid Psychiatric Disorders: Associated Characteristics and Impacts on Maternal Caregivers

Sheilah R. Kring, Jan S. Greenberg, and Marsha Mailick Seltzer, Waisman Center, University of Wisconsin-Madison*

*Academy sponsor

Board #61

Sibling Impact Among Children with and without Developmental Disabilities

Cameron Neece, UCLA, Los Angeles, CA

Room: Georgia Hall–Level One

WEDNESDAY, MAY 23

8:00 am–9:00 am

Academy Business Meeting

10:45 am–12:15 pm

ACADEMY SYMPOSIUM II

Children's Social Competence in Context

Organized by Zolinda Stoneman, University of Georgia

Interventions for the Child Affected by Prenatal Alcohol Exposure

Claire D. Coles, Fetal Alcohol Center, Marcus Institute and Emory University School of Medicine, and Molly Millians and Elles Taddeo, Fetal Alcohol Center, Marcus Institute, Atlanta, GA

Improving the Attitudes of Peers toward Students with Autism

Jonathan M. Campbell, University of Georgia

Friendships and Social Competence—Children with Intellectual Disabilities

Zolinda Stoneman, Institute on Human Development and Disability/UCEDD, University of Georgia

Developmental Trends in Social Cognition for Children with and without Disabilities

Irene Ngai and Frank Floyd, Georgia State University, Atlanta, GA

Discussant: Robert Hodapp, Vanderbilt University, Nashville, TN

3:00 pm–4:15 pm

ACADEMY DISSERTATION AWARD SYMPOSIUM

Perspectives on Sibling Relationships Involving an Individual with Special Needs: A Comparison of Typically Developing Siblings and Parents from American and Korean Cultural Backgrounds

Sun Young Ryu, PhD, Teachers College, Columbia University, New York

Understanding the Relationship between Siblings When One Child Has a Developmental Disability

Joanne Kersh, PhD, Lynch School of Education, Boston College, Boston, MA

Room: Georgia 13–Level One

interactive poster sessions

Exhibit Hall/Georgia Hall | Tuesday and Wednesday

Presenters will be available at the boards at 4:45 pm on Tuesday.

Board #01

"Can You Swallow This?" A Practical Approach to Safe Meal Times

Melissa Evers, Carla Higgins

Board #02

A Comparison of Video Modeling and Video Prompting When Teaching for Independence in a Community Setting

Teresa Taber-Doughty, Stephanie Brennan

Board #03

Access to Supports by School and Community Providers

Renee Patrick, Gayle Stuber

Board #04

Access to Women's Health Care for Women with Disabilities in Delaware

Tracy Lee Mann, MA, Ilka Kristina Riddle, PhD

Board #05

Agreement in the Assessment of Psychopathological Behaviors of Adults with Mental Retardation: Intra-Rater Reliability of the DASH-II

Giulia Balboni, Maria Rosa Valsecchi, Paolo Guzzon

Board #06

Analysis of Psychotropic Medication Use in FXS

Maria Gabriela Valdovinos, Rahul Parsa, Michelle Alexander

Board #07

Are There Benefits to Family Decision-Making in Developmental Disability Services?

Susan Louise Neely-Barnes, Carolyn Graff, Maureen O Marcenko, Lisa Anne Weber

Board #08

Assessing Parent's Needs Regarding Supports for Successful Inclusion of School Age Children with Disabilities in Child Care Settings.

Hamida Jinnah, Zolinda Stoneman, Chris Todd, Anika Francis

Board #09

Assisting Individuals with Intellectual and Developmental Disabilities with Grief and Loss

Sarah Ailey, Susan Breakwell, Marilyn O'Rourke, Anna Murphy

Board #10

Health Education Train-the-Trainer Program: Psychosocial and Physical Health Outcomes

Beth Marks, Jasmina Sisirak, Tamar Heller

Board #11

Biotechnologies, Faith, and Disability: Formulating a Policy Statement from the National Council of Churches

Bill Gaventa, Jr, MDiv

Board #12

Changing Attitudes Among Medical Students Regarding Persons with Disabilities

Anat Ben Zvi

Board #13

Characteristics and Experiences of Persons with Intellectual Disabilities and Mental Illness in Six States

Robert Frank Doljanac, Charlie Lakin, PhD, Soo-Yong Byun

Board #14

Communication Services and Supports: Web Resources for Families and Professionals

MaryAnn Romski, PhD, Rose Sevcik, PhD

Board #15

Correlations between LOC and Assertiveness and Knowledge of Abuse and Decision-Making in Individuals with ID

Anne Spillane

Board #16

Course of Behavioral Change in High-functioning Adults on the Autism Spectrum

Monali Chowdhury

Board #17

The Role of the Religious School in Developing Spiritual Supports in the Local Faith Community: A Case Study

Marvin Miller, MDiv, Teresa Miller

Board #18

Developing Effective Business Plans with People with Disabilities Interested in Entrepreneurship: A Needed Employment Support

Rebecca Brightwell, Patty Cassidy, Zolinda Stoneman

Board #19

Disability Management or Terminal Illness? Use of Gastrostomy Tube Feeding in Persons with Intellectual Disabilities

Allen Sandler

Board #20

Disability Rights and the UN

Rashida Banerjee, Diane M Plunkett

Board #21

Discovering Possibilities and Identifying Supports: Portfolios as a Bridge to Employment and Social Connectedness

Patty Cassidy, Mary Rugg, Zolinda Stoneman

Board #22

Educator Perceptions and Ratings of Pain in School-Age Children with Mental Retardation and Developmental Disabilities

Satomi Kimura Shinde, Frank Symons

Board #23

Evaluating the Sensitivity and Specificity of Depression Screening Tools among Adults with Intellectual and Developmental Disabilities

Sarah Ailey

Board #24

Effective Community Supports for Young Adults—Lessons from a Longitudinal Study of an Institutional Closure

Zolinda Stoneman, Beverly Al-Deen

Board #25

Emotional Math: Threading Emotion and Repetition Together to Improve Memory at T'siya Elementary and Middle School

Anthony Matthew Rodriguez

Board #26

Employee Job Satisfaction and Intent to Turnover in Quasi-Governmental Organizations

Theresa Ann Ricke-Kiely, Richard Ferrante

Board #27

Enhancing Cultural Competency in Services to Persons with Developmental Disabilities in Calgary Alberta, Canada

Stacey Lynn Kowbel, PhD, Nancy Sharara, MA, Donovan Tymchyshyn, MA

Board #28

Homeward Bound: A Roadmap from Long Term Care Settings to Community

Sally Carter, Michelle Schwartz

Board #29

When Case Management Is More than Case Management: Essential Elements of Effective Support Coordination

Michelle Schwartz, Beth Rainer, Carmen Watkins

Board #30

Family Matters: Using Bright Futures to Promote Health & Wellness for Children with Disabilities

Paula Minihan

Board #31

Family Perspectives: Using a Cultural Prism to Understand Families from Asian Cultural Backgrounds

Suk-Hyang Lee, Ann Turnbull, Fei Zan

Board #32

Forensic Competency Issues for Offenders with Mental Retardation

Charlotte Kimmel, PhD

Board #33

Fostering Self-Determination in Infancy and Early Childhood

Hyun-jeong Cho

Board #34

From Research Subject to Researcher: Changing the Role of People with Developmental Disabilities

Kathleen Biersdorff, PhD

Board #35

Health Care Quality Units

Ramona Bosse

Board #36

Teachers Leaders Preparing the Teacher Leaders of Tomorrow

Stephanie Apodaca, Karl DuBois, Valerie Garcia, Kay Osborn, Sarah Price, Donna Rose, Mary Ruckman, Janet Vigil

Board #37

Impact of Multiple Disabilities on the Assessment of Support Needs for People with Intellectual Disabilities

Neil Kirby, Julia Harries, Roma Guscia

Board #38

Inclusion of People with Disabilities in Community and Civic Organizations

Angela Novak Amado, Christina Boice

Board #39

Increasing Appropriate Behavior with Positive Interventions and Support

Nedra Helane Francis

Board #40

Integrating Counseling Practicum Students: A Developmental Center Approach

Neil Edwin Duchac, Chris Stack

Board #41

Intellectual Disability or Autism: Developmental Subscale Differences on the BASC

Laura Murphy, Molly White, Christina Warner

Board #42

Intentional Communication and Self Determination

P R Mitchell

Board #43

Inter-Respondent, Inter-Interviewer and Test-Retest Reliability of the Supports Intensity Scale—French Version

Virginie Cobigo, Diane Morin, Marc Tassé, PhD

Board #44

Lost Not Found: Child Find and Poverty

Kathleen Cooter

Board #45

National Core Indicators Staff Stability Data for Direct Support Personnel

Giuseppina Chiri, Sarah Taub, Josh Engler

Board #46

High School Peer-to-Peer Partnerships

Veronica Moore, Frances Duff

Board #47

Neuropsychological Assessment of Learning Disorders: Road Map to Identify Treatment & Support Needs

Josh Masino

Board #48

Would Adults with Intellectual Disabilities and Their Families Prefer Employment Outside Workshops?

Alberto Migliore

Board #49

Parent Participation and Involvement in Schools: What About Parents of Children with Special Needs?

Louise Lord Nelson, PhD

Board #50

Parental Childhood Social Withdrawal and Offspring Delay: An Intergenerational Study of Prospective Mediators

Alexa Martin-Storey, Jennifer Nachshen, Dale Stack, Alex Schwartzman, Lisa Serbin

Board #51

Peer-to-Peer Assessment of Self-Determination and Quality of Life

Susan Palmer, PhD, Denise Poston

Board #52

PhD in Real Life: Supporting People with Intellectual Disabilities to be Co-instructors and Lecturers in University Disability Studies Programs

Gail Bottoms, Toney Duvall

Board #53

Positive Behavior Support Interventions for Aging Adults with Intellectual Disabilities: A Literature Review

John Gerdtz

Board #54

Proposals for Reducing Healthcare Disparities Affecting Adults with Intellectual/Developmental Disabilities

Margaret Williams

Board #55

Recognition and Treatment of Sensory Processing Disorders in Individuals with Severe Developmental Disabilities

Cynthia Potter, PT, DPT, PCS, ATP

Board #56

Risk as a Debated Concept in Assessing Access to Supports in Alberta, Canada.

Nancy Sharara, MA, Donovan Tymchyshyn, MA, Annalea Sordi, MA

Board #57

Self-Determination in Students with Disabilities: Examining Individual and Ecological Predictors

Karrie Shogren, PhD

Board #58

Self-Directed Supports in the School Environment through Self-Directed IEPs

Jade Delfin

Board #59

Sense and Consents

Hal Baker, Jenny Foster, Chaneth Que-more, Dottie Bell, Rick Rader

Board #60—The ACADEMY POSTER

Adolescents and Adults with Autism Spectrum Disorders with and without Comorbid Psychiatric Disorders: Associated Characteristics and Impacts on Maternal Caregivers

Sheilah R. Kring, Jan S. Greenberg and Marsha Mailick Seltzer, Waismann Center, University of Wisconsin-Madison

Board #61—The ACADEMY POSTER

Sibling Impact Among Children with and without Developmental Disabilities

Cameron Leigh Neece, Bruce Baker

Board #62

Social SiMentor: The Face of E-Learning for the Social Skills of the Workplace

Leslie Walker-Hirsch, Christine Casey, Lucy Baney

Board #63

Social-Behavioral Difficulties and Parental Stress in Families of Children with Developmental Disabilities Receiving Early Intervention Services

Ingrid Edith Sladeczek, Nancy Nevena Miodrag, Anastasia Karagiannakis, Daniel Amar, Jennifer Saracino, Ashleigh Yule

Board #64

Socialization Scale Comparisons for Children with Intellectual Disabilities & Autism

Laura Murphy, EdD, Christina Warner, Molly White

Board #65

Assessing the Supports Needs of Individuals with Prader-Willi Syndrome

Lizabeth Moser-Sadzewicz

Board #66

Nutrition Trends in Children with Developmental Disorders over a 10-Year Period

Shirley Maxine Ekvall, PhD, RD, Valli Kay Ekvall, PhD, RD, Patricia Fugazzi, RD, LALD

Board #67

Support Intensity Scale for the Practice of One's Faith

Rev. Vanessa Ervin, Earl Bleke, Cynthia Padgett, Linda Ogden

Board #68

Supporting Families through a Strengths-based Portfolio Process—How Would You Describe Your Child?

Katy Gregg, Mary Rugg

Board #69

Supports throughout the Transition into School: Changes over Time and Predicting Quality of Life

Tess Clifford, Patricia Minnes, Hélène Ouellette-Kuntz

Board #70

Teaching Medical Students about Caring for People with Disabilities

Laurie Woodard, Kira Zwygart

Board #71

Teaching Preschool Children with Developmental Delays Critical Concepts in Fire Safety: A Sociocultural Approach

Jennifer Lynn Jones, Patricia Ann Self, Deborah Norris

Board #72

The Behavior Checklist: An Analysis of Clinical and Non-Clinical Samples with Intellectual Disabilities

James Tolan, Kristin Adair Droppa

Board #73

The Categorical versus Non-Categorical Approach for Siblings of Children with Genetic Disorders

Ruth Jensen Roberts, Carolyn Graff, Susan Louise Neely-Barnes, Heather Hall, MSN, RNC

Board #74

The Georgia Peer Support Project

Linda Pogue, Darlene Meador, Hilary Elliott, Cheryl Laurendeau, & Andreena Patton

Board #75

The Impact of Sibling Workshops without Stressing on Discussion Activities

Yayoi Kitamura

Board #76

The Legacy Program: A Family Intervention for Late-Life Planning for Individuals with ID

Heidi Layton

Board #77

The Mostly "Off Label" Use of Psychoactive Drugs in Children with Developmental Disabilities

Howard Demb

Board #78

The WHO's Atlas on Intellectual Disability: An International Perspective on the Right to Health for Persons with an Intellectual Disability

Jocelin Lecomte, Céline Mercier

Board #79

They Pick on Me at Work

Annalea Sordi, MA

Board #80

Training of Support Coordinators: an Element Critical for Their Success

Joanna Pierson, PhD

Board #81

Treatment of Self-injurious Hand Mouthing Exhibited by a Three-Year old with Autism

Fletcher Scott

Board #82

Everyone Belongs: A Middle School Journey

Liz Keefe, Stan Agustin

Board #83

How to Recognize and Maintain Safe, Accessible Housing for Persons with Disabilities

Steve McPeake, David Pfriem

Board #84

Working for Justice: Supporting Children and Adults with Disabilities Who Are Victims of Abuse

Jenny Manders

Board #85

Exploring Dimension Iv (Health) In AAIDD Model: How To Use Clinical Diagnostic Data

Luigi Ernesro Croce, Federica Di Cosimo

Board #86

Implementing SIS and ICF Simultaneously: Theoretical and Practical Considerations

Luigi Ernesro Croce, Mauro Leoni, Laura Di Paola

business meetings

MONDAY, 5/21

10:00 am–12:00 noon

AAIDD Board of Directors Meeting

Presiding:
Hank Bersani, Jr., PhD
Atlanta 5–Level One

1:15 pm–3:00 pm

Open Annual Meeting for Members and Leadership Forum

Presiding:
Hank Bersani, Jr., PhD
Capitol South–Level One

3:15 pm–5:00 pm

The Assembly of Geographic Interests

Presiding:
David Rotholz, PhD
Atlanta 4–Level One

3:15 pm–5:00 pm

The Conference of Professional Interests

Presiding: Steve Eidelman
Atlanta 5–Level One

6:00 pm–7:30 pm

T & C Committee Meeting

Presiding:
Robert Schalock, PhD
Atlanta 5–Level One

TUESDAY, 5/22

7:00 am–8:00 am

Journal Editors

Presiding: Bruce Appelgren
Conference Room 125

7:00 am–8:00 am

Religion and Spirituality Division Meeting

Presiding: Rev Jeanne Lloyd
Atlanta 5–Level One

7:00 am–8:00 am

T & C Committee Meeting

Presiding:
Robert Schalock, PhD
Conference Room 127

7:00 am–8:00 am

Multicultural Special Interest Group

Presiding:
Geronimo Robinson
Conference Room 129

8:00 am–8:30 am

Reflection Times: "Integrating Faith and Professional Practice: A Time for Reflection and Meditation"

Atlanta 5–Level One

5:00 pm–6:00 pm

Awards and Fellowship Committee

Presiding:
Carolyn Graff, PhD
Atlanta 1–Level One

5:00 pm–6:00 pm

AAIDD Southern Region

Presiding: Anita Bowles
Atlanta 2–Level One

5:00 pm–6:00 pm

SIS Implementation Committee

Presiding: Val Bradley
Atlanta 5–Level One

5:30 pm–6:30 pm

Nursing Action Group Meeting

Presiding: Lee Barks, PhD
Atlanta 3–Level One

WEDNESDAY, 5/23

7:00 am–8:00 am

DABS Committee

Presiding: Marc Tassé, PhD
Atlanta 3–Level One

7:00 am–8:00 am

Health and Wellness Action Group (HWAG) Breakfast Meeting

Presiding: Barry Martin, MD,
and Lee Barks, PhD
Atlanta 2 –Level One

8:00 am–9:00 am

Archives and Historic Preservation Committee Open Meeting

(members and non members are invited)

Presiding:
Michael Dillon, EdD
Atlanta 4–Level One

8:00 am–9:00 am

Legal Process and Advocacy Division

Presiding: Kelley Peters, PhD
Atlanta 3–Level One

8:00 am–9:00 am

Editorial Advisory Board

Presiding: Bruce Appelgren
Atlanta 1–Level One

8:00 am–9:00 am

Psychology Division

Presiding: Marc Tassé, PhD
Athens–Level Two

2:45 pm–4:15 pm

T&C Open Forum

Presiding:
Robert Schalock, PhD
Atlanta 3–Level One

8:00 am–8:30 am

Reflection Times: "Integrating Faith and Professional Practice: A Time for Reflection and Meditation"

Atlanta 5–Level One

THURSDAY, 5/24

7:00 am–8:00 am

Emergency Preparedness & Hurricane Katrina Action Group

Presiding:
Wendy Nehring, PhD
Atlanta 3–Level One

7:00 am–8:00 am

SIS Sales Team

Presiding: Bruce Appelgren
Atlanta 2–Level One

7:00 am–8:00 am

Social Work Division Meeting

Presiding:
Barbara Hanley, PhD
Atlanta 4–Level One

How's this for **PARTICIPATION?**

See for yourself what our friends with intellectual disabilities can do at church through a

Friendship program.

(More than 600 congregations have already done so.)

■ ■ ■

Let us help you start one!

(We've been at it for 25 years.)



888-866-8966 ■ contact@friendship.org



Registration Schedule

Registration will take place on the Lower Level of the Sheraton Atlanta Hotel. The Registration area will open as follows:

Monday	7:00 am–4:00 pm
Tuesday	7:00 am–5:00 pm
Wednesday	8:00 am–4:00 pm
Thursday	8:00 am–2:30 pm

Admittance to the Annual Meeting Activities

Registrants are required to wear their badges for all meetings, exhibits, and other events. Admittance to all professional meetings as well as other annual meeting activities will be with a badge **only**.

Door monitors will be instructed not to admit non-registered attendees.

AAIDD Market Place

Information on AAIDD membership and publications will be on display in the Exhibit Area during the regular exhibit hours. AAIDD personnel will be available to answer questions.

Silent Auction

A silent auction will be held at the AAIDD Market Place in the Exhibit Hall during regular exhibit hours. Be sure to bid on items of your choice! Biddings close at 12:00 noon on Wednesday, May 23, 2007. *All Items must be picked up by 1:00 pm on Wednesday.*

Prize Drawings

There will be drawings daily in the Exhibit Area. Remember to drop your name in the drum at the AAIDD Market Place.

50/50 Raffle

There will be a 50/50 raffle ongoing throughout the week. The lucky winner will share half the proceeds. The drawing will be held in the Exhibit Hall at 1:00 pm on Wednesday.

Speaker Preparation Room

A speaker preparation room will be available for all speakers on Tuesday and Wednesday.

Room: Georgia 14–Level One

Message Center

The message center will be in the Hall by the Registration Area on Level One. Volunteers will assist you in locating friends and colleagues.

Lost Tickets

There will be NO replacements for lost event tickets. Anyone losing a ticket will have to purchase a new one.

The Exhibit Show Hours

The exhibits are an integral part of the educational program; we invite you to visit them. Admission to the Exhibit Show is free to all registered attendees. A complete listing of exhibitors, the products they are displaying, and their booth locations are listed in the back of this program. (Acceptance of exhibits by AAIDD does not imply an endorsement.)

AAIDD Exhibit Show & Interactive Poster Presentations

We invite you to visit our exhibitors in the Exhibit Hall and contact those companies whose products or services interest you. The exhibits are located in the Exhibit Hall in Georgia Hall. AAIDD thanks all of our exhibitors.

Come support AAIDD's exhibitors and see the newest and the best products and services in the field!

The Exhibit Hall will include a Silent Auction, a 50/50 Raffle, the AAIDD Market Place, and Daily Door Prizes!

Admission to the Exhibit Hall is free to all registered attendees. Poster Presentations will be located inside in the pre-function area and inside the Georgia Hall. Please see page 21 for a complete list of Poster Presentations.

2007 EXHIBITORS

100	Center for Disease Control National Center of Birth Defects and Developmental Disabilities	312	Georgia Community Support & Solutions, Inc.
102	Esteam LLC	313	Somatron Corporation
103	Disability and Human Development, UIC	400	NADD
104	Brookes Publishing Company	401	CARF
200	Friendship Ministries	402	Liberty Healthcare Corporation
201	NISH	403	YAI/National Institute for People With Disabilities Network
202	Therap Services, LLC	404	The Columbus Organization
203	Bethesda Lutheran Homes & Services, Inc.	405	MITC
205	ResCare, Inc.	406	Buddy Bike, LLC
300	Medicine-On-Time	407	AAIDD Religion & Spirituality Division
301	Habilitation Software Inc.	409	Data Systems International
302	Irwin Siegel Agency	410	Evergreen Center
303	Annandale Village	412	This End Up Furniture Co.
304	Albany Advocacy Resource Center	413	Vertex Systems, Inc.
305	Blockhouse Furniture Co Inc	500	Scioto
306	Fundacion John Langdon Down	501	AAIDD Southern Region and the Georgia Chapter
307	College of Direct Support	502	NFP Consultants, Inc.
309	Georgia Mountains Community Services	504	Mutual of America
310	Human Service Connections	506	Pathway at UCLA Extension
		510	AbleLink Technologies

EXHIBIT SCHEDULE

TUESDAY, MAY 22

8:00 am–9:00 am

Exhibit Hall Opening and Poster Presentations

Complimentary Continental Breakfast

12:15 pm–1:45 pm

Exhibit Hall Open and Poster Presentations

4:45 pm–5:45 pm

Exclusive Time for Poster Presentations with Presenters

5:45 pm–7:30 pm

Welcome Reception

Join us for a lively reception in the Exhibit Hall sponsored by AAIDD Southern Region and the Georgia Chapter.

WEDNESDAY, MAY 23

8:00 am–9:00 am

Exhibit Hall Open and Interactive Poster Presentations

Complimentary Continental Breakfast

10:00 am–1:15 pm

Exhibit Hall Open

Coffee Break at 10:15 am
Daily Prize Drawings

exhibits

Georgia Ballroom | Sheraton Atlanta Hotel

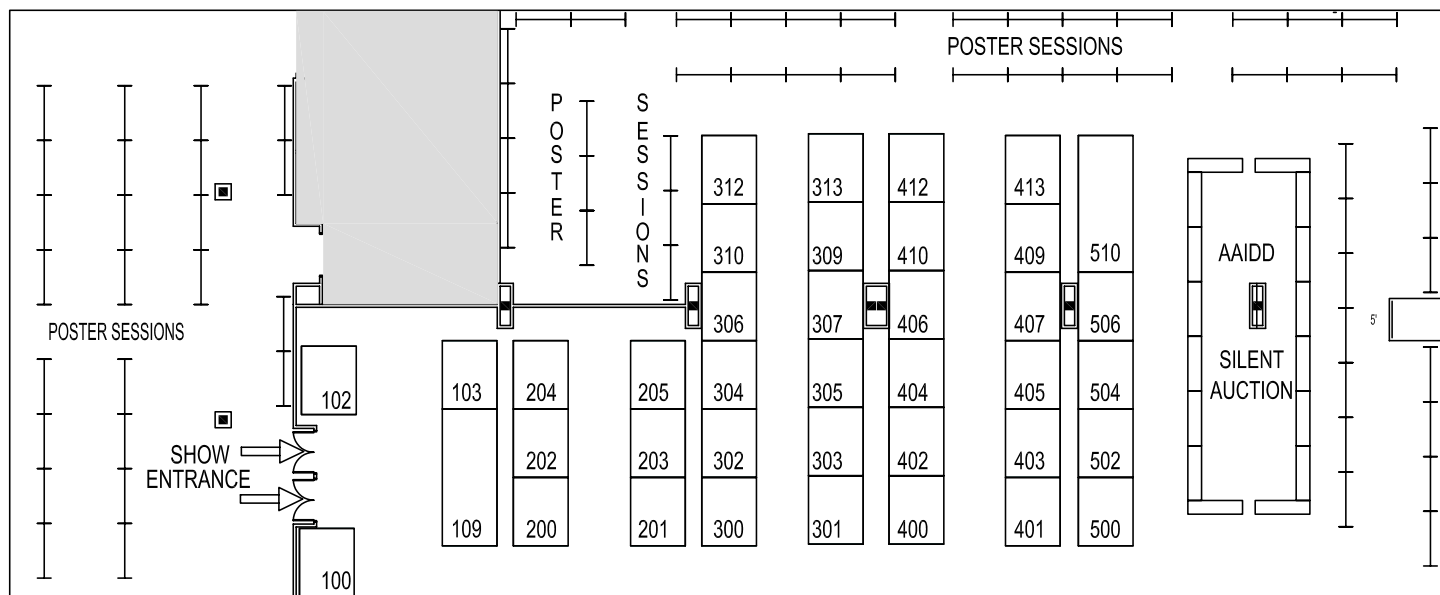

407 AAIDD Religion & Spirituality Division

PO Box 2688, New Brunswick, NJ 08903
 Phone: 732-235-9304, Fax: 732-235-9330
 E-mail: bill.gaventa@umdnj.edu
 Contact: Bill Gaventa, Jr
 Web: www.aaidreligion.org

Books, videos, and other resource materials related to spiritual and community support for people with intellectual and developmental disabilities from a variety of publishers and resource organizations. For religious leaders, agencies, advocates.

501 AAIDD Southern Region and the Georgia Chapter

725 Darlington Circle, Atlanta, GA 30305
 E-mail: mbmuroff@dhr.state.ga.us
 Contact: Mickie B. Muroff
 Web: www.seaamr.org

510 AbleLink Technologies

528 N Tejon, Colorado Springs, CO 80903
 Phone: 719-592-0347
 E-mail: nfisk@ablelinktech.com
 Contact: Dan Davies, Founder/President
 Web: www.ablelinktech.com

AbleLink Technologies has more than 15 different Cognitive Support Technologies that enable individuals at every level of ability to live and work more independently.

304 Albany Advocacy Resource Center

PO Box 71026, Albany, GA 31707
 Phone: 229-888-6852, Fax: 229-888-6875
 E-mail: abowling@albanygaarc.org
 Contact: Annette Bowling, Executive Director
 Web: www.albanyarc.org

Purpose: Dignity, Personal Freedom and acceptance, continually helping persons with disabilities is the goal of Albany ARC. Being a part of their community has been a life long dream of many persons with disabilities. One small step is how a walk down the road of dignity, freedom, and a meaningful life.

303 Annandale Village

3500 Annandale Ln, Suwanee, GA 30024
 Phone: 770-945-8381, Fax: 770-945-8693
 E-mail: adampomeranz@annandale.com
 Contact: Adam Pomeranz, Executive Director
 Web: http://www.annandale.org

The mission of Annandale Village is to perpetuate a village community to provide a progressive life assistance to adults with developmental disabilities so they can maximize their abilities and maintain their independence in the least restrictive environment.

203 Bethesda Lutheran Homes & Services, Inc.

600 Hoffmann Dr, Watertown, WI 53094
 Phone: 920-261-3050, Fax: 920-262-6513
 E-mail: bharring@blhs.org
 Contact: Brenda Harrington
 Web: www.blhs.org

Now in its second century of service, Bethesda Lutheran Homes and Services Inc provides services and supports to individuals with developmental disabilities throughout the country and throughout the world. It is Bethesda's mission to support the needs of the individual - both physical and spiritual - and as a result Bethesda offers many different types of services for the individual and their family.

305 Blockhouse Furniture Co Inc

3285 Farmtrail Rd, York, PA 17406-5602
 Phone: 717-764-5555, Fax: 717-767-8939
 Email: dbeshore@blockhouse.com
 Contact: Donna Beshore, Trade Show Coordinator
 Web: www.blockhouse.com

Providing furniture for special needs since 1971, Blockhouse Furniture Co. is a forerunner in the design and manufacture of durable hardwood and finely upholstered furniture.

104 Brookes Publishing Company

PO Box 10624, Baltimore, MD 21285
 Phone: 410-337-9580, Fax: 410-337-8539
 E-mail: mallred@brookespublishing.com
 Contact: Melanie Allred, Exhibits Coordinator
 Web: www.brookespublishing.com

For over 27 years, Brookes Publishing has been a leading provider of resources on education, disabilities, child development, early intervention, communication, language, behavior, and mental health. An independent company, Brookes Publishing is headquartered in Baltimore, Maryland.

406 Buddy Bike, LLC

2775 Sunny Isles Blvd - Ste 118, North Miami Beach, FL 33160
 Phone: 786-489-2453, Fax: 305-932-6585
 E-mail: shelley@buddybike.com
 Contact: Shelley Patterson, Business Manager
 Web: www.buddybike.com

The Buddy Bike provides safe family fun and special needs bicycling. Unique tandem design places your child in front while you steer from behind.

401 CARF

4891 E Grant Rd, Tucson, AZ 85712
 Phone: 520-325-1044, Fax: 520-318-1129
 E-mail: rbibby@carf.org
 Contact: Renée Bibbly
 Web: www.carf.org

CARF is an independent, nonprofit organization that promotes the quality, value, and optimal outcomes of services through a consultative accreditation process that centers on enhancing the lives of the persons served.

100 Center for Disease Control National Center for Birth Defects and Developmental Disabilities

1600 Clifton Rd Atlanta, GA 30333
 phone: 404-498-3974
 fax: 404-498-3060
 contact: Curt Shannon
 email: cbq9@cdc.gov

307 College of Direct Support

1400 E 5th Ave
 Knoxville, TN 37917
 phone: 865-524-5555
 fax: 865-524-5563
 email: bill@collegeofdirectsupport.com
 contact: Bill Tapp
 web: www.collegeofdirectsupport.com

Teh College of Direct Support is a learning gateway for best contemporary practices in direct care. Based on the Community Supports Skills Standards, the CDS is being used in over 26 states and numerous agencies to support a profession of direct care.

404 The Columbus Organization

1012 W 9th Ave, King of Prussia, PA 19406
 Fax: 888-379-2524
 E-mail: asborlini@columbusorg.com
 Contact: Amy Sborlini
 Web: www.columbusorg.com

Columbus is the nation's leading provider of onsite professional staffing and consultative services, focusing exclusively on agencies that serve individuals with special needs. Columbus is an organization of professionals who have extensive expertise in clinical practice, clinical research, staff training, forensic issues, litigation issues, recruiting professional staff, and developing policies and procedures at developmental centers and state hospitals.

409 Data Systems International

545 E 4500 S - Ste E260, Salt Lake City, UT 84107
 Phone: 801-451-2885, Fax: 866-224-4506
 Email: brian@data-systems.com
 Contact: Brian Bingel, President
 Web: www.clienttrack.net

Case Management Software utilize to track intakes, Services Provided, Programs, enrollments and report outcomes.

103 Disability and Human Development, UIC

1640 W Roosevelt Rd- #436, Chicago, IL 60608
 Phone: 312-413-1466, Fax: 312-413-1630
 E-mail: maitha@uic.edu
 Contact: Martha Abogado
 Web: www.ahs.uic.edu/dhd

Department of Disability and Human Development, University of Illinois at Chicago is dedicated to the scholarly, interdisciplinary study of disability, and related aspects of human development.

102 Esteam LLC

504 Beaver St, Sewickley, PA 15143-1799
 Phone: 412-749-1010, Fax: 412-749-1799
 E-mail: chartzell@esteam.net
 Contact: Carolyn Hartzell, Director of Administration
 Web: www.esteam.net

For human services organizations, clinicians, executive management and finance teams, Total: Impact provides the most comprehensive suite of software, strategic consulting services and deployment expertise for significantly improving the performance of human services organizations.

410 Evergreen Center

345 Fortune Blvd, Milford, MA 01757
 Phone: 508-478-2631, Fax: 508-634-3251
 E-mail: nmanske@evergreenctr.org
 Contact:
 Web:

Evergreen Center is a community based residential treatment program serving children with Mental Retardation, Autism, Dual Diagnosis, physical challenges and severe maladaptive behavior using Applied Behavior Analysis and functional teaching strategies.

306 Fundación John Langdon Down

Selva #4 Col - Insurgentes Cuicuilco, Mexico City
 Phone: 52-55-5666-8580, Fax: 52-55-5606-3809
 E-mail: angelicagonzalez@fjldown.org.mx
 Contact: Angelica Gonzalez
 Web: www.fjldown.org.mx

The John Langdon Down Foundation is a not-profit organization that provides educational services for people with Down Syndrome and their families.

200 Friendship Ministries

2215 29th St SE - #B6, Grand Rapids, MI 49508
 Phone: 616-301-7729, Fax: 616-301-7761
 Email: friendship@friendship.org
 Contact: Nella Uitvlugt, Executive Director
 Web: www.friendship.org

Friendship Ministries provides a one-on-one mentoring model for nurturing spirituality in people who have cognitive impairments, encouraging them to become active members of their faith community. Training, consulting, and curriculum are available.

312 Georgia Community Support & Solutions, Inc.

1945 Cliff Valley Way - Ste 220, Atlanta, GA 30529
 Phone: 404-634-4222, Fax: 404-634-1324
 E-mail: whitney.fuchs@gacomunity.org
 Contact: Whitney Fuchs, Executive Director
 Web: www.gacomunity.org

Georgia Community Support & Solutions is a nonprofit organization that provides personal supports and services throughout the Greater Atlanta counties for children and adults with disabilities, mental health, emotional or substance abuse issues.

309 Georgia Mountains Community Services

4331 Thurmond Tanner Rd, Flowery Branch, GA 30542
 Phone: 678-513-5700, Fax: 678-513-5831
 E-mail: rsgrisham@gamins.org
 Contact: Carol Perkins, Services Director
 Web: www.gamtns.org

To promote safe, stable and meaningful lives, GMCS Partners with individuals, families and communities to minimize barriers for persons with mental health, developmental disabilities, addictive diseases and similar life challenges.

301 Habilitation Software Inc.

204 N Sterling St, Morganton, NC 28655
 Phone: 828-438-9455, Fax: 828-438-9488
 E-mail: randy@habsoft.com
 Contact: Randy Herson, President
 Web: www.habsoft.com

Developers of The Personal Planning System Enterprise Edition, a person centered planning documentation and tracking system emphasizing best practices and ease of use. Continuously improved for over twenty years.

310 Human Service Connections

PO Box 833, New Lenox, IL 60451
 Phone: 815-462-7762, Fax: 815-462-7784
 E-mail: cindy@humanserviceconnections.com
 Contact: Cindy Haworth, Principal
 Web: www.humanserviceconnections.com

Executive leadership recruitment and development services exclusively for the developmental disability field. HSC is staffed with experienced professionals to help you find leaders outside your organization or develop those within.

302 Irwin Siegel Agency

25 Lake Louise Marie Rd, Rock Hill, NY 12775
 Fax: 845-796-3661
 Email: dawn.maas@siegelagency.com
 Contact: Dawn Maas
 Web: www.siegelagency.com

Irwin Siegel Agency, Inc. (ISA) is a leading provider of insurance and risk management services within the Human Services Field. Areas include Developmental Disabilities, Community/Social Services and Behavioral Healthcare.

402 Liberty Healthcare Corporation

401 City Ave - Ste 820, Bala-Cynwyd, PA 19004
 Phone: 610-668-8800, Fax: 610-668-7689
 E-mail: carolw@libertyhealth.com
 Contact: Carol Wertley, Senior Administrator
 Web: www.libertyhealth.com

Liberty Healthcare is a National Medical Management Corporation with 30 years experience with contracts in twenty states. We pride ourselves in hiring topnotch candidates to work as a team with highly qualified interdisciplinary professionals. The team's responsibility is to develop/implement functional assessments for individuals with Intellectual and Developmental Disabilities.

300 Medicine-On-Time

200 International Circle - Ste 1300, Hunt Valley, MD 21117
 Phone: 800-833-2266, Fax: 800-386-8788
 E-mail: jkmotga@msn.com
 Contact: John D. Kalvelage
 Web: www.medicine-on-time.com

Medicine-On-Time is a medication management system provided by a network of over 400 community pharmacies nationwide. Patient and time specific dose cups are assembled in color coded calendar frames to reduce complexity and increase both patient compliance and caregiver convenience. Call us for a provider in your area or visit us @ www.medicine-on-time.com.

405 MITC

11791 Fingerboard Rd, Monrovia, MD 21770
 Phone: 800-959-1888
 E-mail: info@mitcsoftware.com
 Contact: Julie Minor, Director of Marketing
 Web: www.mitcsoftware.com

Automated Time and Attendance, Scheduling, Piece and Production, Payroll, Accounting, and Case Management. Agencies throughout the USA use MITC Software.

504 Mutual of America

320 Park Ave, New York, NY 10022
 Phone: 212-224-1707, Fax: 212-224-2527
 E-mail: tom.macmurray@mutualofamerica.com
 Contact: Tom Macmurray
 Web: www.mutualofamerica.com

MUTUAL OF AMERICA has specialized in providing retirement plan products and services to not-for-profit organizations and their employees since 1945. We also offer voluntary retirement savings plans, including 401(k), 403(b) and Section 457 deferred compensation plans, group insurance, individual annuities and insurance products.

400 NADD

132 Fair St, Kingston, NY 12401
 Phone: 845-331-4336, Fax: 845-331-4569
 Email: rfletcher@thenadd.org
 Contact: Dr. Robert Fletcher, CEO
 Web: www.thenadd.org

NADD's mission is to advance mental wellness for persons with developmental disabilities through the promotion of excellence in mental healthcare. NADD offers a wide selection of materials including the Diagnostic Manual for Persons with Intellectual Disability.

502 NFP Consultants, Inc.

4179 Crescent Dr - Ste A, St. Louis, MO 63129
 Phone: 800-632-6372, Fax: 314-894-1844
 E-mail: andyh@nfpconsultants.com
 Contact: Andy Harleman, Account Manager
 Web: www.nfpconsultants.com

Fund accounting, fundraising, and HR software solutions. Booth is staffed by forms Administrator of Supported Living organization.

201 NISH

8401 Old Courthouse Rd, Vienna, VA 22182
 Phone: 571-226-4669, Fax: 703-288-9146
 E-mail: dperka@nish.org
 Contact: Denise Perka
 Web: www.nish.org

NISH is a national nonprofit agency whose mission is to create employment opportunities for people with severe disabilities through the Javits-Wagner-O'Day (JWOD) Program.

506 Pathway at UCLA Extension

10995 Le Conte Ave - Ste 413, Los Angeles, CA 90024
 Phone: 310-794-1235, Fax: 310-494-1235
 E-mail: elatham@uclaextension.edu
 Contact: Eric Latham
 Web: www.uclaextension.edu/pathway

Pathway at UCLA Extension is an innovative post-secondary education and enrichment program for young adults with intellectual and other developmental disabilities who want to embark on a path of lifelong learning to prepare for the future. Pathway offers a full educational, vocational, cultural and social curriculum in a specialized learning environment.

205 ResCare, Inc.

10140 Linn Station Rd, Louisville, KY 40223
 Phone: 502-394-2135, Fax: 502-394-2181
 Email: lweishaar@rescare.com
 Contact: Larry Weishaar, Vice President
 Web: www.rescare.com

ResCare is a human service company providing residential, therapeutic, job training and educational support to people with intellectual, developmental or other disabilities; education and training to youth in the Job Corps program; one-stop employment and training services for people experiencing barriers to employment; and support to older people in their homes.

500 Scioto

5970 Wilcox Pl - Ste H, Dublin, OH 43016
 Phone: 614-889-5191, Fax: 614-889-5202
 E-mail: kmcnulty@scioto.com
 Contact: Kate McNulty, Regional Director of Business Development
 Web: www.scioto.com

Scioto provides a national comprehensive housing solutions business for individuals with disabilities and residential providers that support them. Focusing solely on housing Scioto has garnered significant experience and developed the capabilities to deliver community housing anywhere in the country. For more information view Scioto's website at www.scioto.com.

313 Somatron Corporation

9401 N 14th St, Tampa, FL 33612
 Phone: 813-935-7740, Fax: 813-935-7745
 E-mail: kim@somatron.com
 Contact: Byron Eakin, President
 Web: www.somatron.com

The Somatron Corporation is the leader in Vibroacoustic Therapy. Vibroacoustic Therapy occurs when music is converted to tactile sensations which permeate your whole body with stimulating and soothing sound vibrations.

202 Therap Services, LLC

562 Watertown Ave - Ste 3, Waterbury, CT 06708
 Phone: 203-596-7553, Fax: 203-755-5116
 E-mail: syeed@therapservices.net
 Contact: Syeed Khandker, Marketing
 Web: www.therapservices.net

Therap Services provides secure online documentation, communication, and reporting services designed specifically for the developmental disability community. Modules include: Health tracking, billing, Incident reporting, demographics, individual goal tracking, behavior tracking, staff training and schedules.

412 This End Up Furniture Co.

211 Wagner Rd, Evans City, PA 16033
 Phone: 724-538-9861, Fax: 724-538-8109
 E-mail: fabioruberto@thisendup.com
 Contact: Fabio Ruberto, National Sales Director
 Web: www.thisendup.com

This End Up furniture is comfortable, beautiful, and will fit your needs and budget. Living areas, bedrooms, dining rooms... any room, our selection of versatile and durable furniture will create a relaxed, home like environment. This End Up Furniture is unbeatable value—the one, the only, the original... This End Up!

413 Vertex Systems, Inc.

705 Lakeview Plaza Blvd - Ste J, Worthington, OH 43085
 Phone: 614-318-7100, Fax: 614-318-7145
 Email: schandler@vertexsystems.com
 Contact: Sanford Chandler, President
 Web: www.vertexsystems.com

Vertex creates intuitive, cost-effective information-management software for organizations that serve people with disabilities. We focus on their unique requirements, helping them meet the complex demands of their consumers, regulators and funding sources.

403 YAI/National Institute for People With Disabilities Network

460 W 34th St - 11th Fl, New York, NY 10001
 Phone: 212-273-6255, Fax: 212-629-4113
 E-mail: aimee.hoffner@yai.org
 Contact: Aimee Hoffner, Assistant Manager
 Web: www.yai.org

YAI/National Institute for People With Disabilities is a nationally acclaimed provider serving more than 20,000 individuals with ID/DD. YAI/NIPD is also a major producer of training materials for staff and consumers.

hotel floor plan

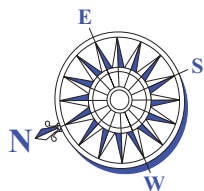
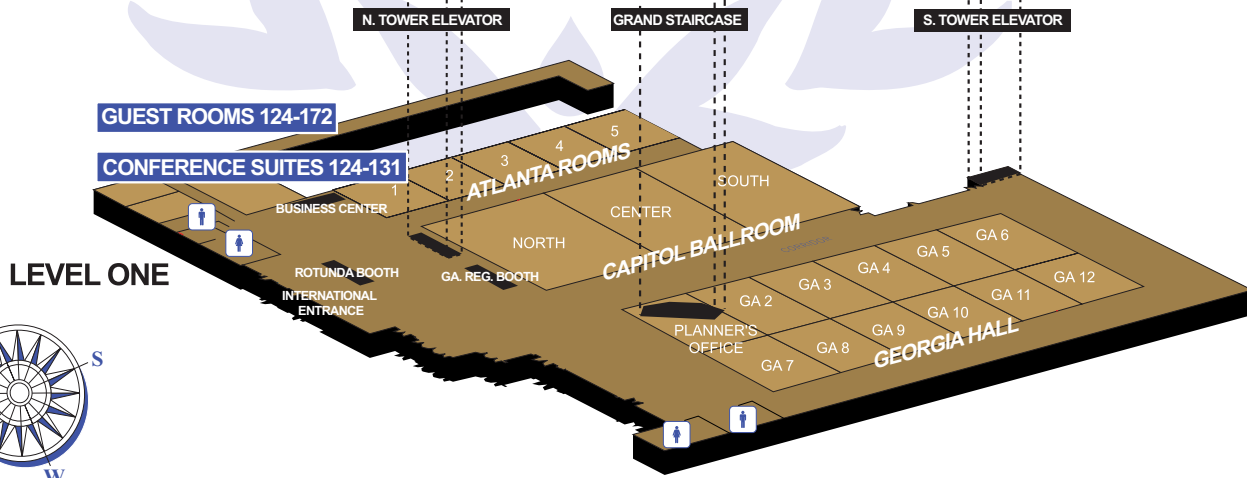
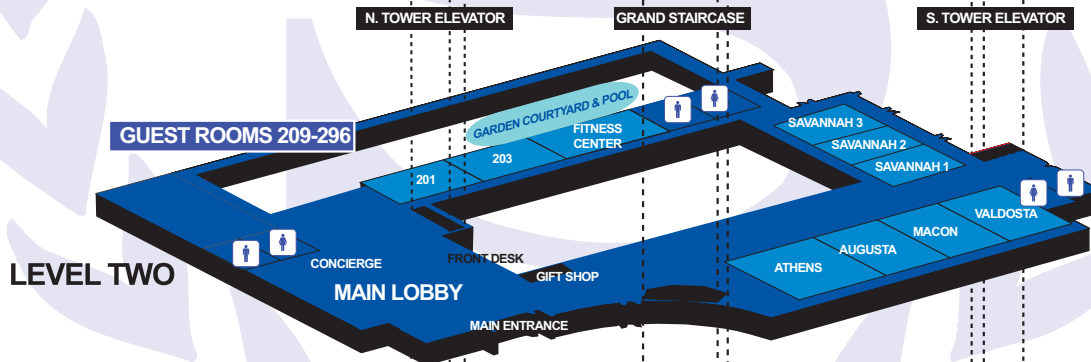
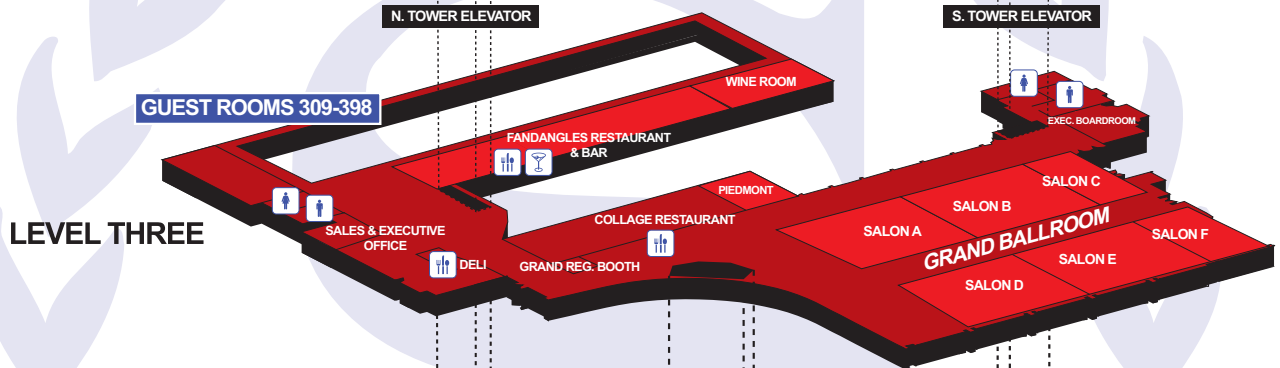
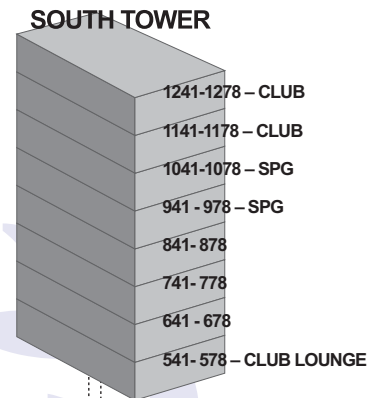
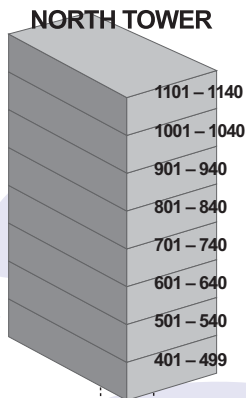

LEVEL ONE

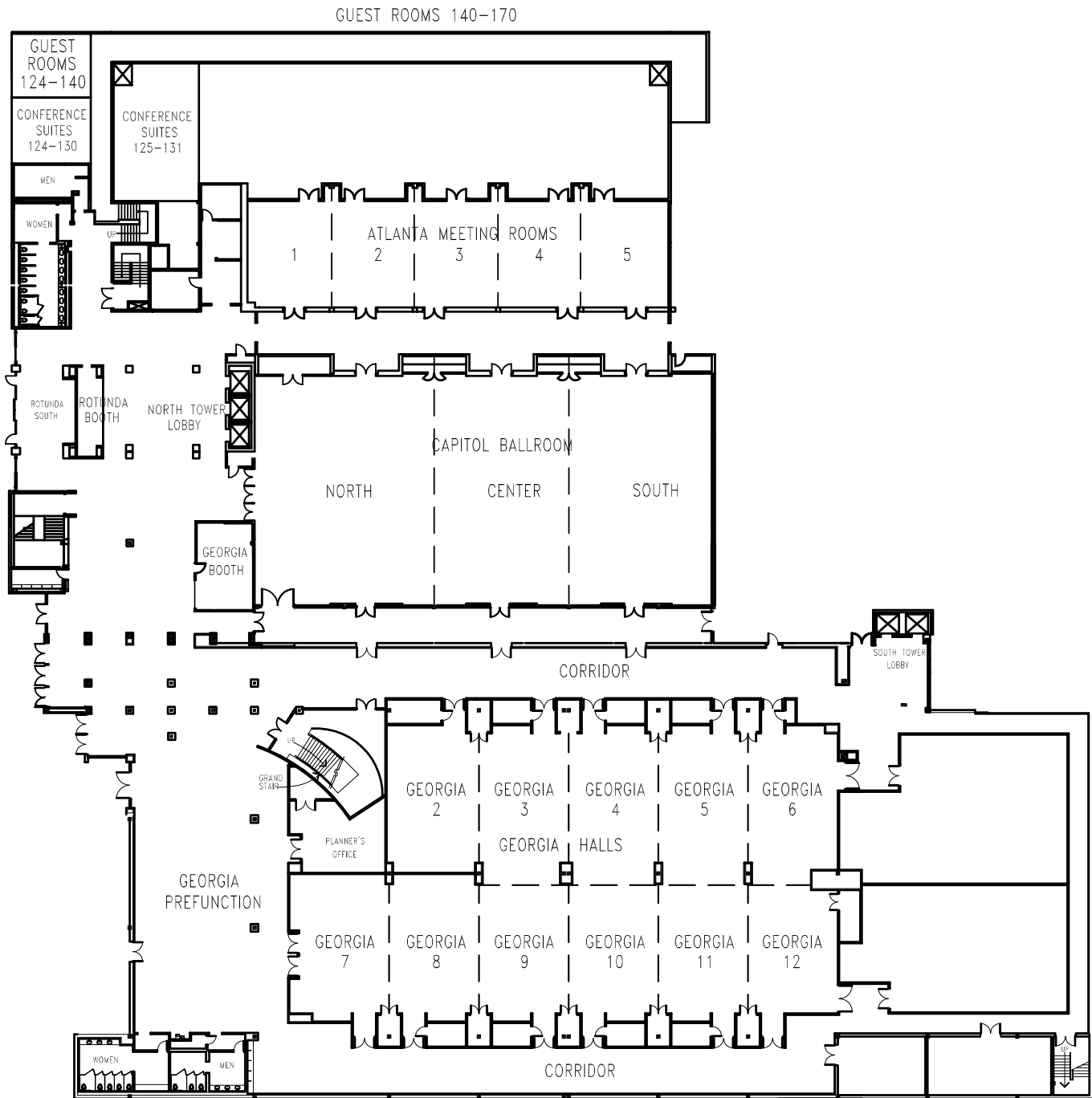

LEVEL TWO

GUEST ROOMS 241-270

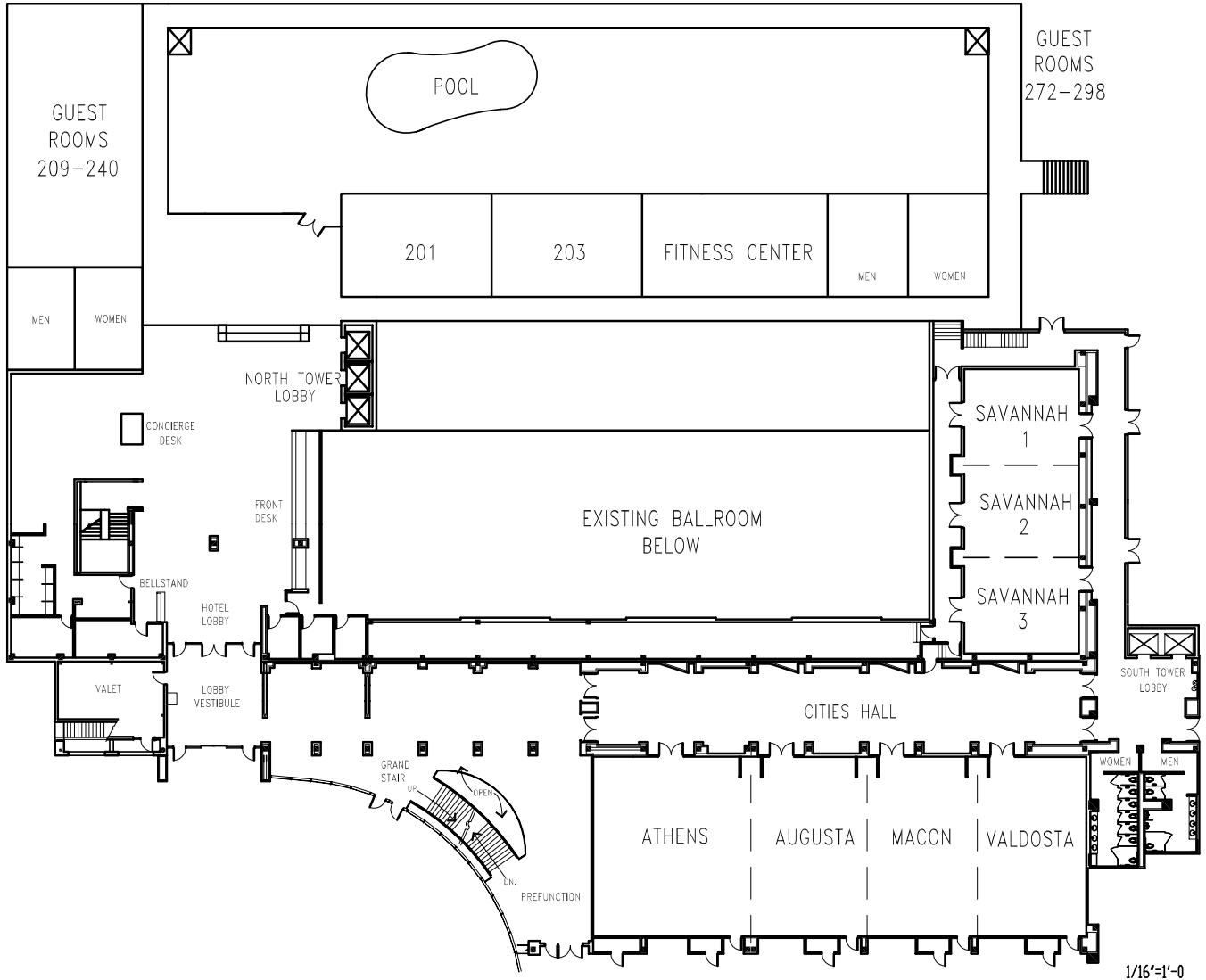

aaidd leadership

Board of Directors

Hank Bersani Jr., PhD
President

David A. Rotholz, PhD
President-Elect

Steven M. Eidelman
Vice President

Joanna L. Pierson, PhD
Secretary/Treasurer

Valerie J. Bradley
Immediate Past President

Members-at-Large

Sharon C. Gomez
Susan M. Haverkamp, PhD
Wayne P. Silverman, PhD
Mark H. Yeager, PhD
Michael L. Wehmeyer, PhD

Diane Morin, PhD
Canadian Member-at-Large

Bernard J. Carabello
Presidential Advisor

M. Doreen Croser
Executive Director

Editors

Steven J. Taylor, PhD
William E. MacLean, Jr, PhD

AAIDD Personnel

Laura Abulafia
Paul D. Aitken
Maria A. Alfaro
Bruce Appelgren
Saihanjula He
Betty C. Margallo
Ana M. Montoulieu
Anna Prabhala
Yvette Taylor

Conference Planning Committee

David Rotholz, PhD, chair
Sharon Gomez, co-chair
Carolyn Graff, PhD
Amy Hewitt, PhD
Sid Katz
Kathi Lacy, PhD
Wayne Silverman, PhD
Alma Stewart

New 30-Year AAIDD Members

William F. Abright, PhD	Ronald E. Kozlowski
Ellis Arnstein, MD	David B. Lane, Jr.
Michael Bender, EdD	Barbara L. Ludlow, EdD
Daniel Berkowicz	William E. MacLean, PhD
Rosalie M. Boldin	Terrence W. Macy, PhD
June O. Bond, EdD	Mary K. Madsen, PhD
Sharon A. Borthwick-Duffy, PhD	Jerome Margolis
Thomas G. Bowman, PhD	Gary B. Mesibov, PhD
Marcia B. Bryan, EdD	Christopher R. Milar, PhD
Dana L. Brynelsen	Sara R. Miller
Stephen B. Cannon, PhD	Mary Jo Noonan, PhD
Robert L. Carl, PhD	Brendan M. O'Connell
Leroy O. Carlson, MD	John R. Pekar
Mary C. Cerreto, PhD	Christine M. Regan
Patricia Ann Childs	Jacques H. Robinson, PhD
Ronnie L. Cornelison	Rebecca S. Salon, PhD
Charles E. Cummins	Allen G. Sandler, PhD
Derrick F. Dufresne	Howard C. Schneider, PhD
Ronald S. Ebert, PhD	Martin D. Schwartz
James W. Ellis, JD	Robin Shaw
Jean N. Farley	Valerie E. Smith
Richard R. Farnsworth	Margaret P. Sparr
Robert J. Fleese	George D. Stack
George A. Foelker, Jr., PhD	Jack A. Stark, PhD
Glenn T. Fujiura, PhD	John P. Stefanik
Eileen M. Furey, PhD	Robert J. Steronko
Laraine M. Glidden, PhD	Robert A. Stodden, PhD
Wayne A. Greenleaf, PhD	Zolinda Stoneman, PhD
Arlyne J. Gutmann, PhD	Mary Alice Storey
Stephen J. Harris	Kenneth A. Thrasher, PhD
Sandra E. Herman, PhD	Linda J. Thurston
Rita Honan, PhD	Kathleen S. Tice
Alan P. Hore, PhD	Mary M. Tjosvold, PhD
Melvyn L. Hughes	Normand A. Tremblay
Lewis B. Jackson, EdD	Kevin K. Walsh, PhD
Larry A. Jones, JD, PhD	Marian M. Weeks, PhD
Joseph B. Keyes, PhD	David A. Wyher
Rosalind Kopfstein, DSW	Angela Yaron, PhD
	Steven J. Zider, PhD

Y'all come back now, you heah?

Announcing the second edition!

Positive Behavior Support Training Curriculum

The only evidence-based Curriculum to train supervisors and direct support staff in positive behavior support strategies !

Order Now!

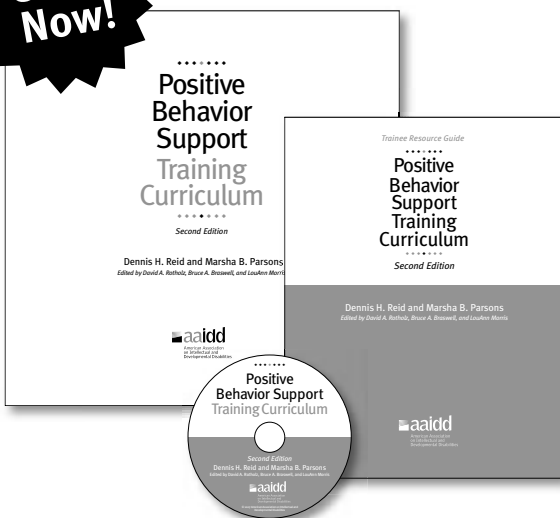

“The PBSTC is an excellent training tool. The Curriculum includes the acquisition and mastery of trainee performance skills that are essential to practicing PBS in work settings.”

Carolyn Greene, School Administrator,
J. Iverson Riddle Developmental Center, North Carolina

“We are using the PBSTC as part of our pre-service training program and eventually all of our 600 employees will be trained with this Curriculum. I have recommended without hesitation the PBSTC to my colleagues who espouse a PBS philosophy as well as those who are grounded in Applied Behavior Analysis.”

Michael F. Dorsey, Director of Clinical Services,
Mental Retardation Division, Vinfen, Massachusetts

New to the second edition!

- ◆ Combines supervisor and direct support editions into one efficient Curriculum
- ◆ Contains wider selection of activities to work with people with varying degrees of intellectual disability
- ◆ Ready-to-use PowerPoint slides now on CD-ROM
- ◆ Simplified trainee activities make learning easier for staff
- ◆ Several modules combined to reduce total training time

The PBSTC continues to deliver

- ◆ A tested, stable, and successful source of positive behavior support strategies to reduce challenging behavior
- ◆ Performance and competency-based Curriculum requiring in-class activities, role plays, and on-the-job demonstration of skills
- ◆ Trains supervisors on managerial duties, including staff observations, performance analysis, and evaluating PBS plans
- ◆ “Right out of the box” trainer curriculum comes with activity sheets, skills checks, and PowerPoint slides on CD-ROM!
- ◆ Fosters ample student and teacher interaction with enjoyable team activities
- ◆ Proven to create culture of respect for people with intellectual disabilities

The PBSTC Set includes a handsome 3-ring binder, a Trainee Resource Guide for note taking, and a CD-ROM with training slides. There are 25 total modules in the Curriculum, out of which 9 are additional material for Supervisors. The same applies to the Training Resource Guide. Purchase as many Trainee Resource Guides as number of trainees in your programs.

PBSTC Set			
No. 380	420 pp.	\$395.00	
Trainee Resource Guide			
No. 381	156 pp.	\$10.95	
Curriculum Overheads on CD-ROM			
No. 382		\$9.95	

American Association
on Intellectual and
Developmental Disabilities

RESERVE YOUR COPY NOW!

PHONE: 301-604-1340
FAX: 301-206-9789
WEB: <http://bookstore.aaid.org>
(starting July 2007)

MAIL: AAIDD Publications
P.O. Box 25
Annapolis Junction, MD 20701-0025

Available
July
2007

Past Presidents

The history of the AAIDD is long and distinguished. Our tradition, professional standing, and leadership in the area of intellectual and developmental disabilities are exemplified in the persons of our Presidents.

Our former Presidents are:

1876-1877	Edouard Sequin, MD	1922-1923	C. Banks McNairy, MD	1962-1963	William Sloan, PhD
1877-1878	Hervey B. Wilbur, MD	1923-1924	Walter E. Fernald, MD	1963-1964	George L. Wadsworth, MD
1878-1879	G. A. Doren, MD	1924-1925	Groves B. Smith, MD	1964-1965	Harvey A. Stevens
1879-1880	H. M. Knight, MD	1925-1926	Arthur R. T. Wylie, MD	1965-1966	I. Ignacy Goldberg, EdD
1880-1881	Charles T. Wilbur, MD	1926-1927	Benjamin W. Baker, MD	1966-1967	Marguerite J. Hastings
1881-1882	George W. Brown, MD	1927-1928	Edward R. Johnstone	1967-1968	Harvey F. Dingman, PhD
1882-1884	J. Q. A. Stewart, MD	1928-1929	George E. McPherson, MD	1968-1969	Richard Koch, MD
1884-1885	A. H. Beaton, MD	1929-1930	George L. Wallace, MD	1969-1970	Wesley D. White, EdD
1885-1886	F. M. Powell, MD	1930-1931	H. H. Ramsey, MD	1970-1971	Horace Mann, PhD
1886-1887	William B. Fish, MD	1931-1932	Harvey M. Watkins, MD	1971-1972	Robert L. Erdman, EdD
1887-1888	George H. Knight, MD	1932-1933	Howard W. Potter, MD	1972-1973	Michael J. Begab, PhD
1888-1889	J. C. Carson, MD	1933-1934	Ransom A. Greene, MD	1973-1974	David Rosen, MS
1889-1890	A.C. Rogers, MD	1934-1935	Mary M. Wolfe, MD	1974-1975	James D. Clements, MD
1890-1891	J. T. Armstrong, MD	1935-1936	Edgar A. Doll, PhD	1975-1976	Sue Allen Warren, PhD
1891-1892	Isaac N. Kerlin, MD	1936-1937	Benjamin O. Whitten, MD	1976-1977	Burton Blatt, EdD
1892-1893	Walter E. Fernald, MD	1937-1938	Harry C. Storrs, MD	1977-1978	Margaret J. Giannini, MD
1893-1894	A. E. Osborne, MD	1938-1939	Neil A. Dayton, MD	1978-1979	Richard C. Scheerenberger, PhD
1894-1895	A. W. Wilmarth, MD	1939-1940	Frederick Kuhlmann, PhD	1979-1980	Marjorie H. Kirkland, MSSW
1895-1896	Samuel J. Fort, MD	1940-1941	Meta L. Anderson, PhD	1980-1981	H. Carl Haywood, PhD
1896-1897	Martin W. Barr, MD	1941-1942	Fred O. Butler, MD	1981-1982	Frank A. Borreca, EdD
1897-1898	George A. Brown, MD	1942-1943	Horatio M. Pollock, PhD	1982-1983	A. Gail O'Connor, PhD
1898-1899	Mary J. Dunlap, MD	1943-1944	C. Stanley Raymond, MD	1983-1984	Herbert J. Grossman, MD
1899-1900	Alexander Johnson	1944-1945	E. Arthur Witney, MD	1984-1985	B. R. (Bill) Walker, PhD
1900-1901	W. A. Polglase, MD	1945-1946	Mabel A. Matthews	1985-1986	H. Rutherford Turnbull III, LLB, LLM
1901-1902	F. W. Keating, MD	1946-1947	Warren G. Murray, MD	1986-1987	Harold Michal-Smith, PhD
1902-1903	J. M. Murdoch, MD	1947-1948	Lloyd N. Yepsen, PhD	1987-1988	Valaida S. Walker, EdD
1903-1904	Edward R. Johnstone	1948-1949	Edward J. Humphreys, MD	1988-1989	Robert G. Griffith, EdD
1904-1905	A. H. Beaton, MD	1949-1950	Mildred Thomson	1989-1990	James W. Ellis, JD
1905-1906	George Mogridge, MD	1950-1951	Richard H. Hungerford	1990-1991	Robert R. Bruininks, PhD
1906-1907	W. H. C. Smith, MD	1951-1952	Edward J. Engberg, MD	1991-1992	Jack A. Stark, PhD
1907-1908	Charles Bernstein, MD	1952-1953	Bertha M. Luckey, PhD	1992-1993	Michael R. Dillon, EdD
1908-1909	W. N. Bullard, MD	1953-1954	Arthur T. Hopwood, MD	1993-1994	David L. Braddock, PhD
1909-1910	Miss Mattie Gundry	1954-1955	Gale H. Walker, MD	1994-1995	Karen L. Middendorf
1910-1911	Arthur R. T. Wylie, MD	1955-1956	Arthur E. Westwell, DMD	1995-1996	William E. Kiernan, PhD
1911-1912	H. G. Hardt, MD	1956-1957	Thomas L. McCulloch, PhD	1996-1997	Pamela C. Baker, PhD
1912-1913	Allan E. Carrol, MD	1957-1958	Chris J. DeProsopo, EdD	1997-1998	Robert L. Schalock, PhD
1913-1914	J. K. Kutnewsky, MD	1958-1959	George Tarjan, MD	1998-1999	Stanley S. Herr, J.D., DPhil
1914-1915	H. H. Goddard, PhD	1959-1960	Frances M. Coakley	1999-2000	Bernard R. Wagner, PhD
1915-1916	Charles Bernstein, MD	1960-1961	Edward L. Johnstone	2000-2001	Cathy Ficker Terrill, MS
1916-1917	E. J. Emerick, MD	1961-1962	Herschel W. Nisonger	2001-2002	Steven F. Warren, PhD
1917-1918	George L. Wallace, MD			2002-2003	Ruth A. Luckasson, JD
1918-1919	Charles S. Little, MD			2003-2004	Ann P. Turnbull, EdD
1919-1920	George S. Bliss, MD			2004-2005	David L. Coulter, MD
1920-1921	H. A. Haynes, MD			2005-2006	Valerie J. Bradley, MA
1921-1922	Joseph H. Ladd, MD				



Knowledge | Support | Empowerment